

INSTRUCTION MANUAL

SRX85Te

1/8 SCALE

**Instruction
Manual**

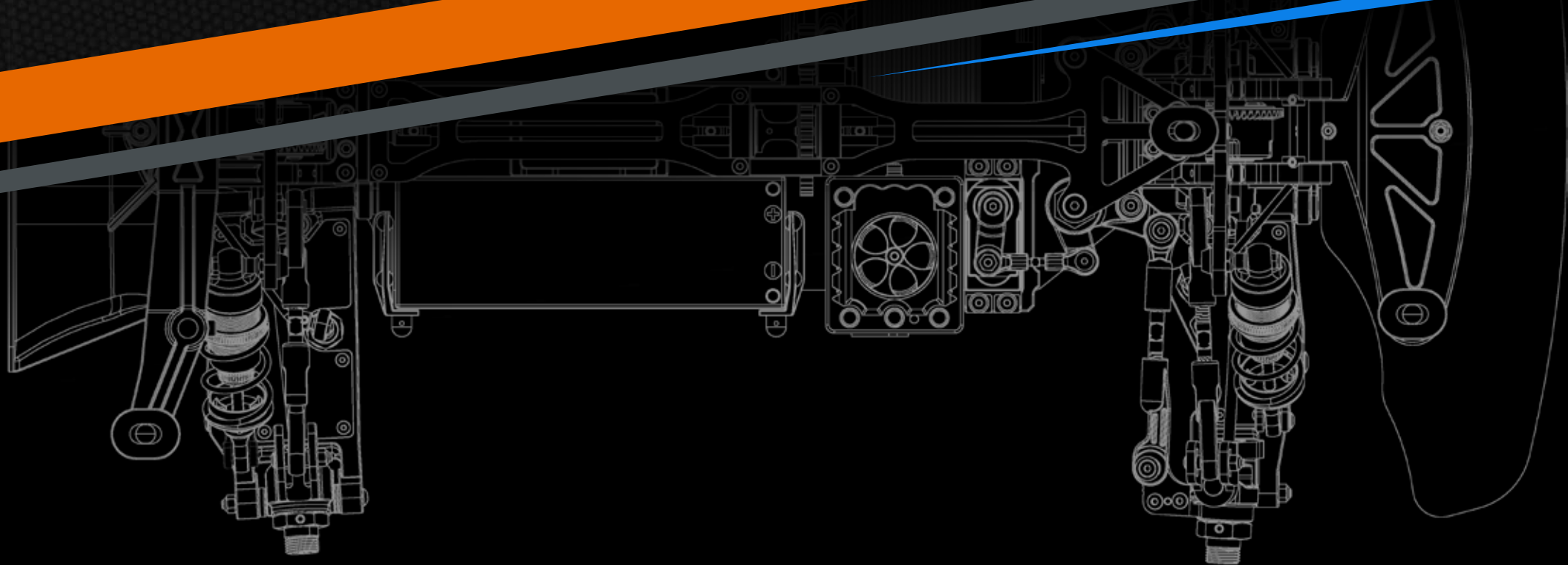

SERPENT

INTRODUCTION

Thank you very much for selecting this Serpent rc car and thus become a member of the ever growing worldwide Serpent racing family. Serpent started in 1980 and has been growing its product-line and fan-base ever since.

The Serpent Cobra SRX8 GTE is a state of the art 1/8 scale 4wd GT which will give you the true Serpent racing experience. The assembly manual will guide you through all the steps to complete the car, so you can hit the track with a good base-set-up soonest. The Serpent design department succeeded to create a superbly performing car combined with ease of assembly and maintenance. The high quality standards of all parts and hardware will make racing your Serpent car a very rewarding activity !

Through our team, website and social media we will keep you up-to-date on all developments of the Serpent cars. We hope to meet you on the track and through our various media! Enjoy the drive !

Team Serpent
Multiple World Champions

INSTRUCTIONS

Serpent's long tradition of excellence extends to the instruction manuals, and this instruction manual is no exception. The easy-to-follow layout is richly illustrated with 3D-rendered full-color images to make your building experience quick and easy. Following the instructions will result in a well-built, high-performance race-car that will soon be able to unleash its full potential at the racetrack. The kit includes bags, with bagnumbers, which refer to the same step in the manual. Open only the indicated bag(s) per step and finish that part of the assembly. Remaining parts will be needed later on in the assembly process.

PLASTIC PARTS

The Serpent moulded parts are very durable and hard. When assembling longer screws in new composite parts, make sure to use new hex bits in your (power) tools. Pre-threading also helps to avoid screw damage.

SETUP

In certain assembly steps you need to make basic adjustments, which will give you a good initial setup for your Serpent Cobra SRX8 GTE. Fine-tuning the initial setup is an essential part of building a high-performance racecar like your Serpent Cobra SRX8 GTE.

EXPLODED VIEWS AND PARTS LIST

The exploded views and parts lists for the Serpent Cobra SRX8 GTE are presented in the Reference Guide section in the back of this manual. The exploded views show all the parts of a particular assembly step along with the Serpent part number and hotlink to the Serpent website. Partnumbers in orange indicates that this part is an optional. Optionals part names and numbers are showed below.

CUSTOMER SERVICE

Serpent has made a strong effort to make this manual as complete and clear as possible. Additional info may be published in our website: www.serpent.com or you may ask your dealer or the Serpent distributor for advice, or email Serpent direct: info@serpent.com. The Serpent Facebook, Twitter and Youtube pages give additional means of support and communications.

SAFETY

Read and take note of the 'Read this First section' before proceeding to assemble the car-kit. This car-kit is intended for persons aged 16 or older.

READ THIS FIRST!

- This is a highly technical hobby product, intended to be used in a safe racing environment. This car is capable of speeds in excess of 80 km/h or 50mph. Please follow these guidelines when building and operating this model.
- Parental guidance is required when the builder/user of this car is under 16.
- Follow the building instructions. If in doubt, contact your dealer or importer.
- Be sure to use the proper tools when assembling the car. Always exercise caution when using electric tools, knives and other sharp objects.
- Be careful when using liquids like lubrication oil, fuel or glue. Do not swallow.
- Follow the manufacturer's instruction in case you experience irritation after using the product.
- Be careful when operating the car. Stay away from any rotating parts such as wheels, gears and transmission. Stay away from motor, engine and exhaust pipe system or speedo during and immediately after use, as these parts may be very hot. We advise to use protective hand gloves.
- Only operate this car in a safe environment, like a special racing track or a closed parking lot. Avoid using this car on public roads, crowded places or near infants.
- Before operating this car, always check the mechanical status of the car. Also check that the transmitter and receiver frequencies correspond and are not used by any other racer at the same time. Check that the batteries of the transmitter and receiver- are fully charged.
- After use, always check all the mechanics of the car. We advise to clean the car immediately after use, and inspect the parts for wear or fractures. Replace when necessary. Do not use water, methanol, thinner or other solvents to clean the car.
- Empty the fuel tank (depending on model) if needed and disconnect the receiver battery.
- Store the car in a dry and heated place to avoid corrosion of metal parts.
- Avoid using this car in wet conditions as the water will cause corrosion on the metal parts and bearings and these parts will cease to function properly. If driven in the wet, ensure that all the electric equipment is waterproofed and after use, that all moving parts are dried immediately.

CONTENTS

- **FR/RR DIFF ASSEMBLY.....4**
- **CENTER SOLID AXLE ASSEMBLY.....6**
- **REAR ASSEMBLY.....7**
- **FRONT ASSEMBLY.....12**
- **CENTAL ASSEMBLY.....17**
- **STEERING ASSEMBLY.....19**
- **SHOCKS ASSEMBLY.....23**
- **FIAL ASSEMBLY.....27**
-

LINES DESCRIPTION

Each step contains a variety of numbers, lines, and symbols. The numbers represent the order in which the parts should be assembled. The lines are described below.



Step number; the order in which you should assemble the indicated parts



Length after assembly



Assembly path of one item into another



Group of items (within lines) should be assembled first



Direction the item should be moved



Glue one item to another



Press/insert one item into another



Connect one item to another



Gap between two items

ICONS DESCRIPTION

Each step contains a variety of symbols described below.



Carefull, read and check very well.



Apply a small amount of cyano glue. Use wear protection for eyes and hands.



Detail view to explain assembly or order of parts better.



Default set-up: This symbol indicates the default setup.



Grease: apply a small amount of grease to the parts shown.



Left and right parts should be assembled in the same way.



Thread lock: apply a small amount on the parts shown. Before to apply the threadlock, make sure to degrease the parts very well, as otherwise the threadlock will not work.



Silicone oil: use the indicated silicone oil for the shocks and differentials.



Parts or items not included in the kit.



Optional part, not standard in the kit.

STEP 1 FR/RR DIFF BAG

1.1

6x11.75x0.2

2.5x12

M3x4

8x16x5

1

GR

Note the correct pin location.

1.2

8x16x5

2.5x12

6x11.75x0.2

SO Use silicone oil to hold seal in position.

Note the correct pin location.

STEP 2

2.1

VOLUME COMPENSATORS

When the differential gets hotter, the foam inserts will absorb the pressure of the expansion of the oil.

- 1- The supplied foam tube must be cut to size as indicated here below.
- 2- Penetrate them fully with same differential oil.
- 3- Insert them in the compensator holes.

14.7 - 14.9 mm

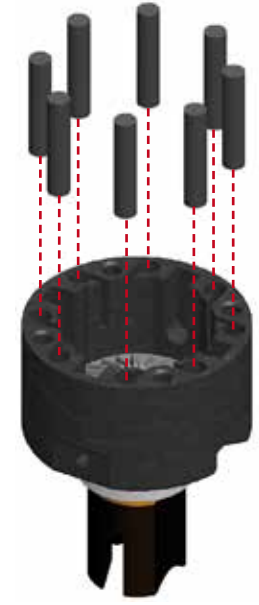

2.2

Add just enough oil to cover the large gear before assembling the small satellite gears and cross pins.

Use the silicone oil supplied in the kit. For the correct cst value please check the default setupsheet.

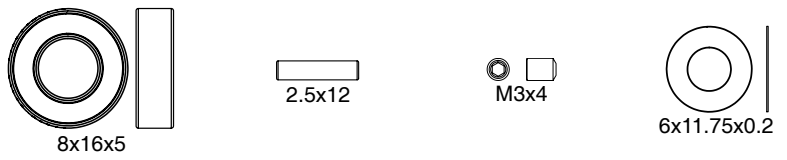

STEP 3

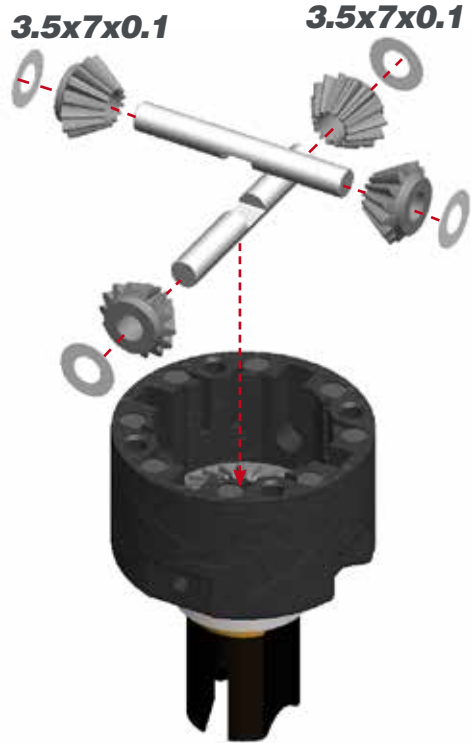

STEP 4



Fill the differential with silicone oil 1 mm above the crosspin, do NOT overfill. Use the silicone oil supplied in the kit. For the correct cst value please check the default setupsheet.

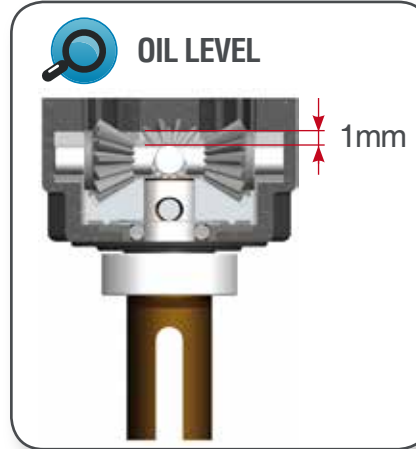

AMOUNT OF OIL IN THE DIFFS

Use a digital scale to measure the exact amount of oil in the diff.

Differential weight with volume compensators = 40.15 grams

Differential weight without volume compensators = 40.35 grams



STEP 5

M3x14

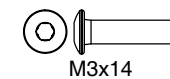
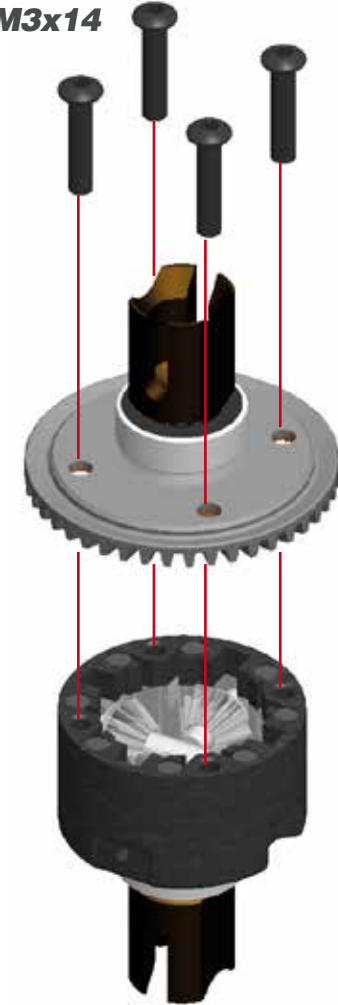

STEP 6 SOLID AXLE BAG

6.1

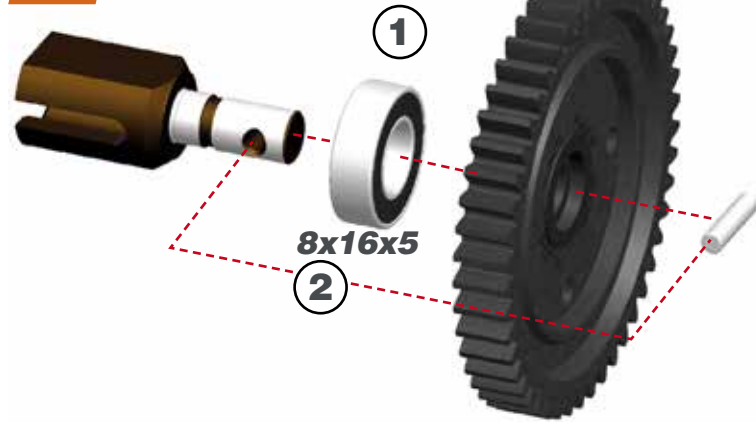

6.2

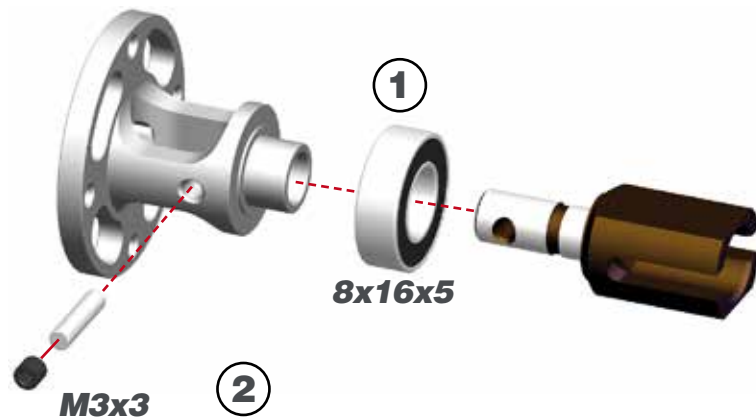

6.3

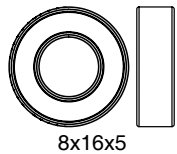
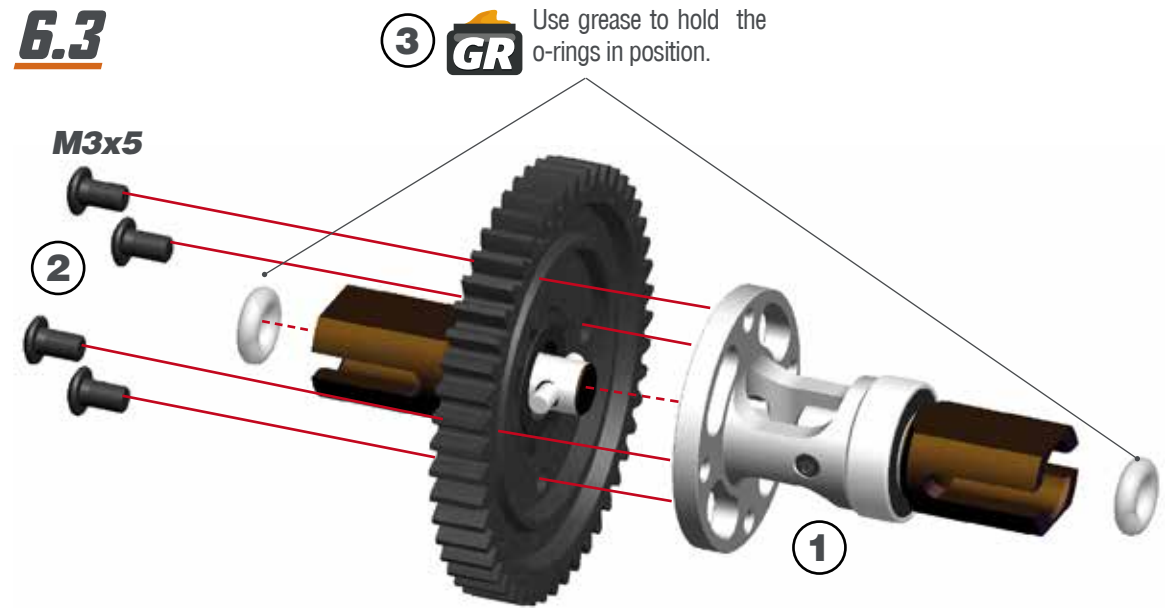

STEP 7 BAG 1

7.1 **L=R**

! Tighten anti-roll bar cap until there is no play, and it moves freely.

ANTIROLL BAR ROD LENGTH
34 mm

7.2

M2.5X6

M2.5X6

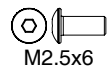

STEP 8

8.1

M4x12

REAR ANTISQUAT INSERTS CHART

L=R				
1	15	2	25	3
●	●	●	●	●
DEF. SETUP				

8.2

M4x12

REAR TOE IN INSERTS CHART

L=R						
2	2.5	2.75	3	3.25	3.5	4
●	●	●	●	●	●	●
DEF. SETUP						

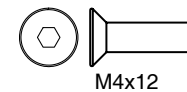

STEP 9

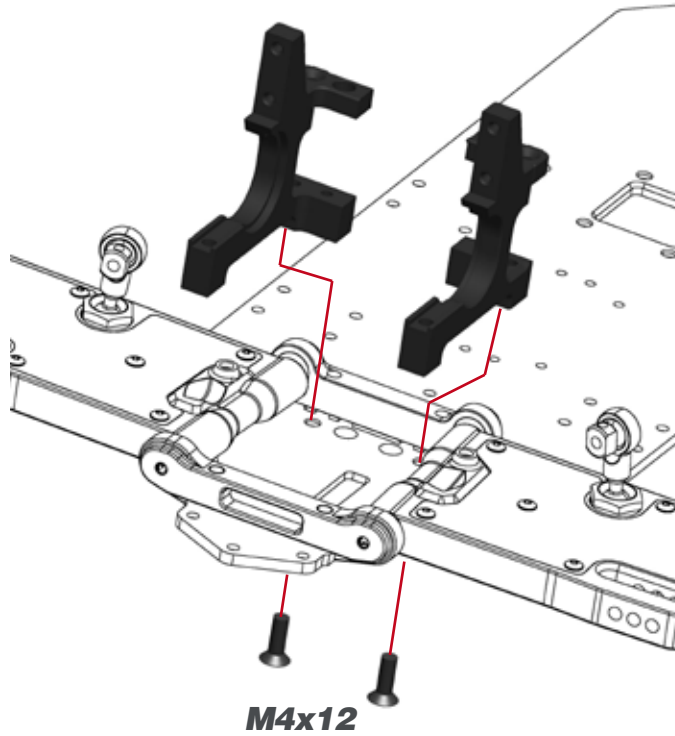





STEP 10 BAG 2

10.1

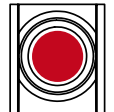
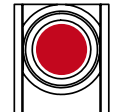

! After building the differential with new gears, new differential case and bearings, the diff may feel a little tight. The connected parts need at least an hour run-time to create a perfect match. Attention: When you assemble the diff with too much initial play, the gears will not run-in properly and may wear quickly. After 1 or 2 hours of running the car, re-check the gear-mesh between the ring gear and the pinion. All parts should have run-in properly now. You may add or remove 8x11x0.1 shims as needed.

INDRIVE BRACKETS CHART
Assemble the indrive bracket accordingly to the diff insert assert mounted in the step 18.

	LOW		MID LOW		MID HIGH		HIGH
			NI		NI		



DEF. SETUP

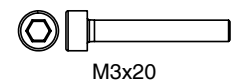
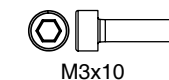
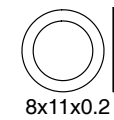
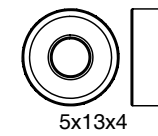
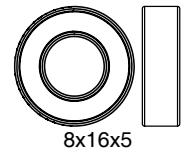
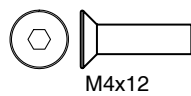
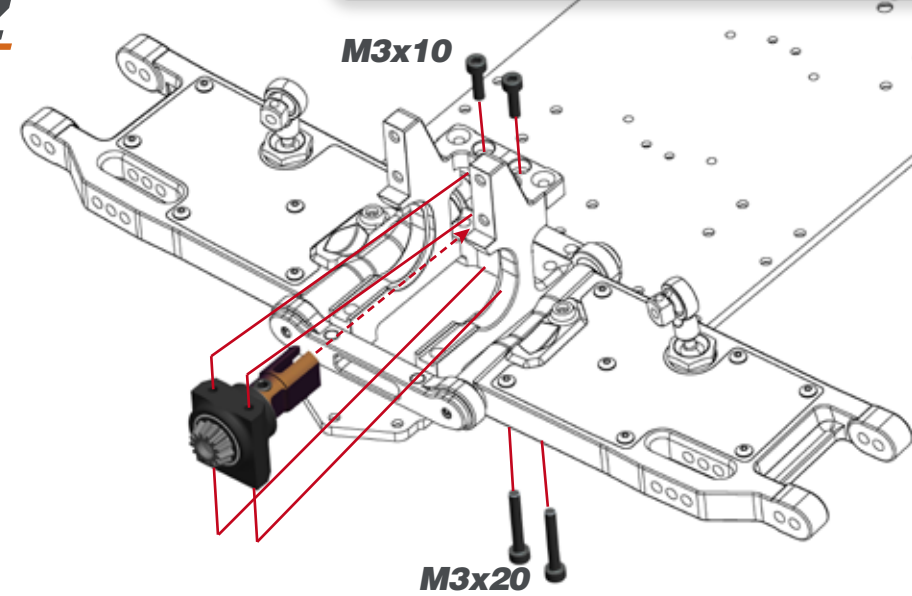

10.2

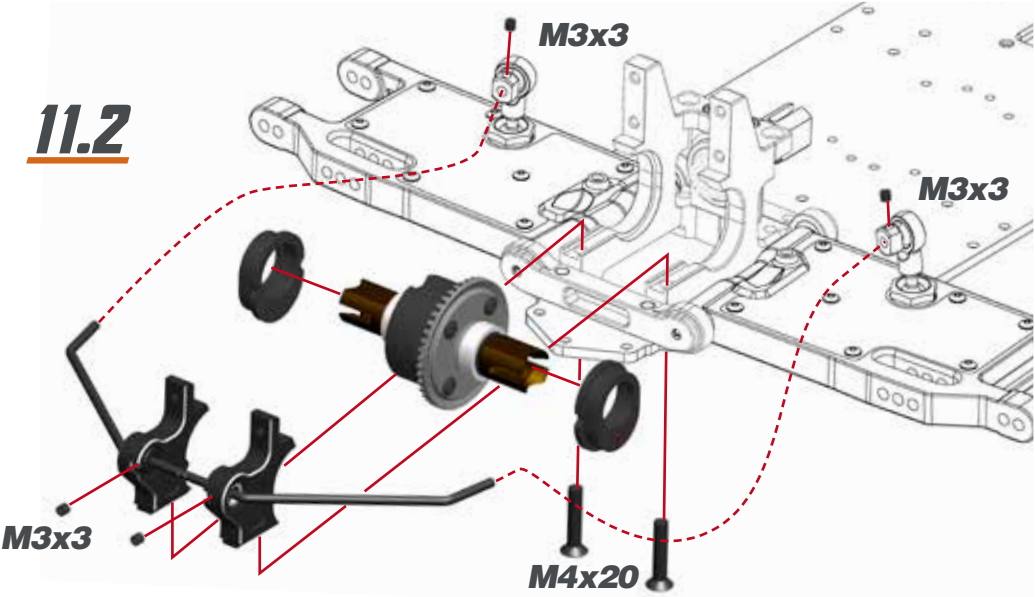
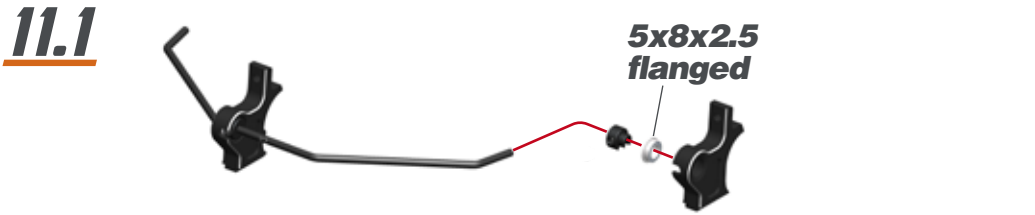

STEP 11

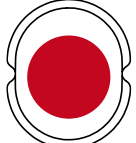

 **DIFF INSERTS CHART** 

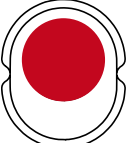
 LOW	 MID LOW	 MID HIGH	 HIGH
--	--	---	--

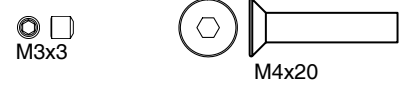

STEP 12

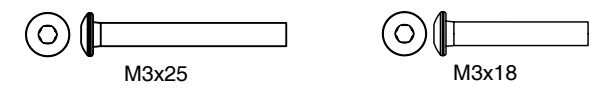
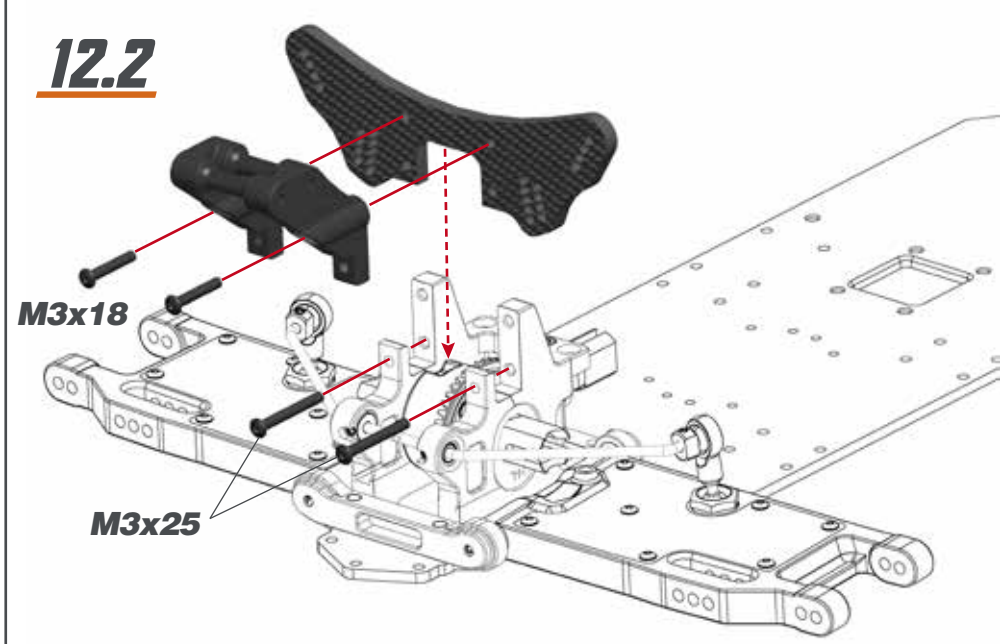
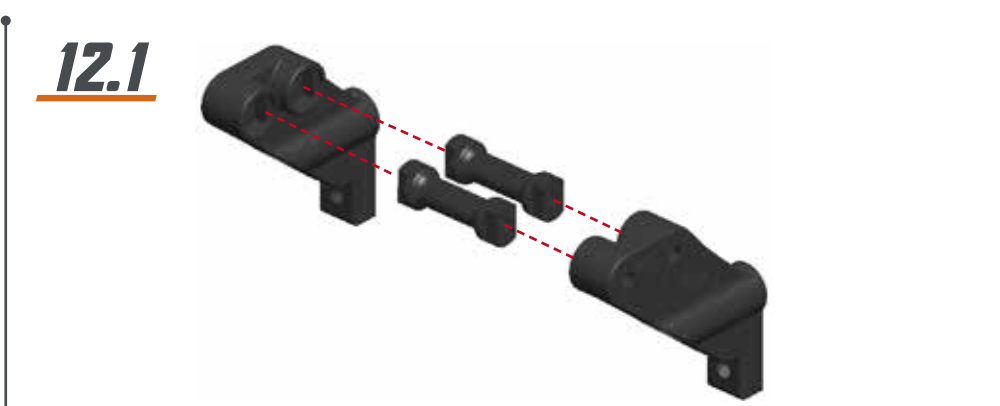

STEP 13





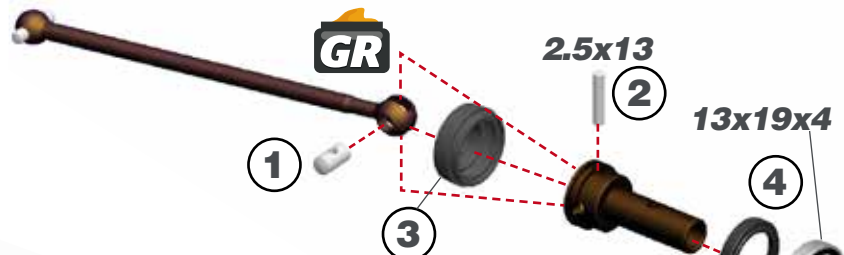



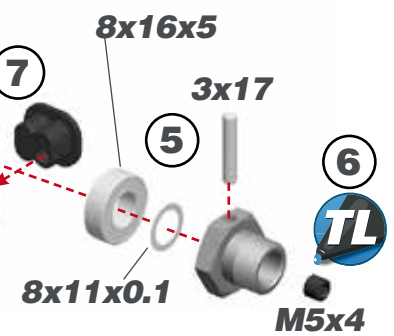
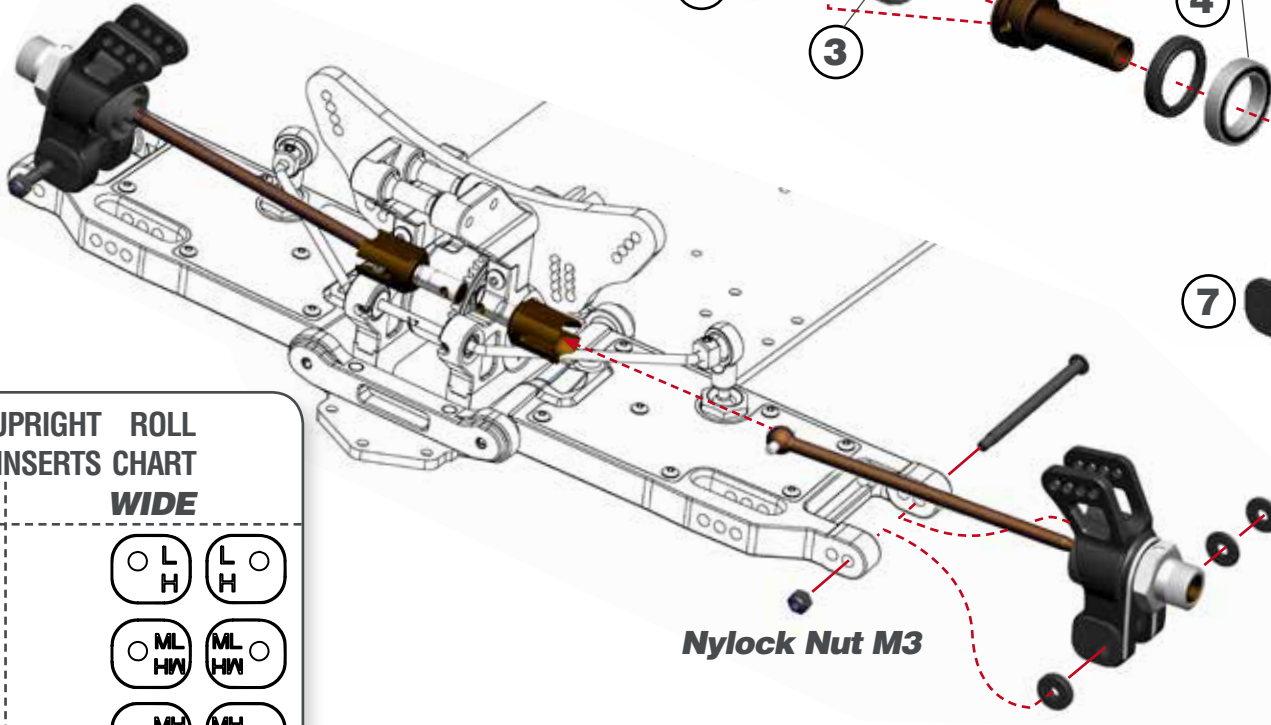

BAG 3

13.1 L-R

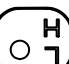

13.2



REAR UPRIGHT ROLL CENTER INSERTS CHART	
NARROW	WIDE
	
	
	
	
	
	

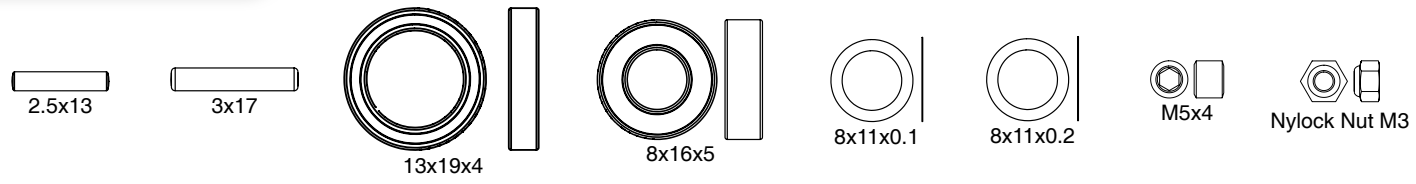

STEP 14

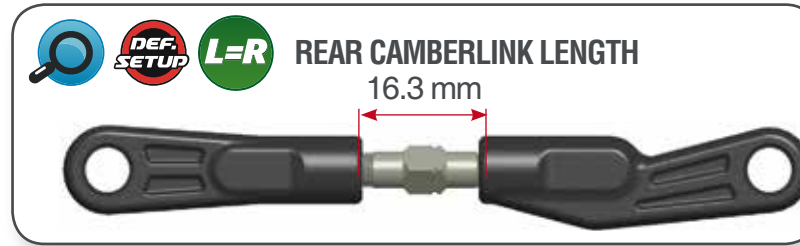

14.2

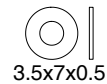
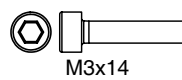
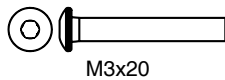
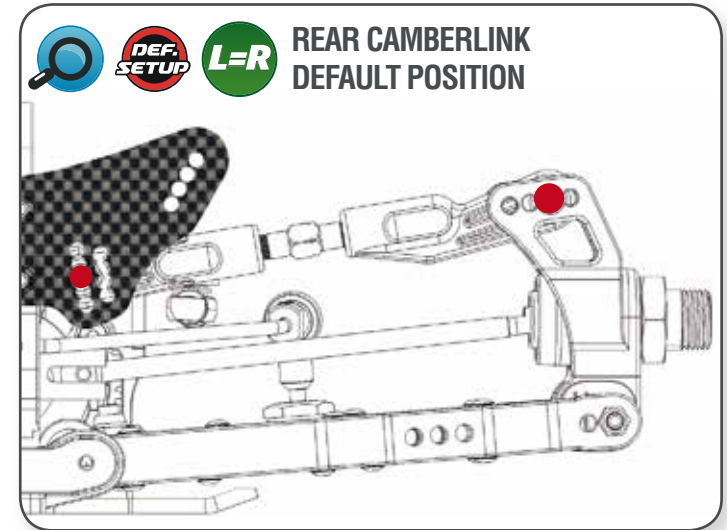
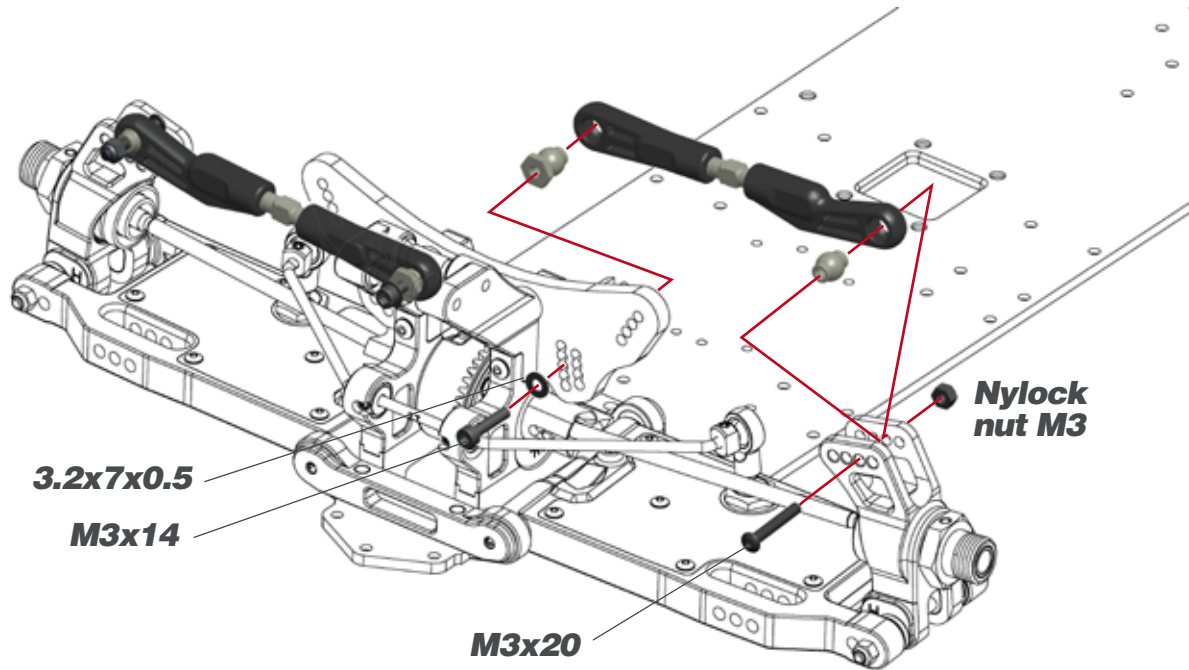

STEP 15

BAG 4

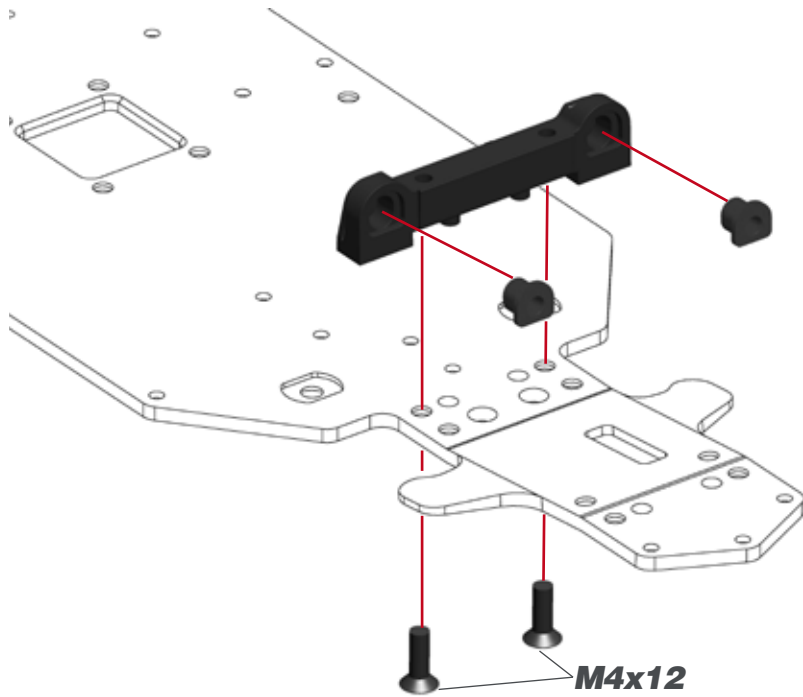

M4x12

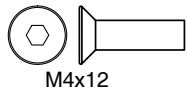
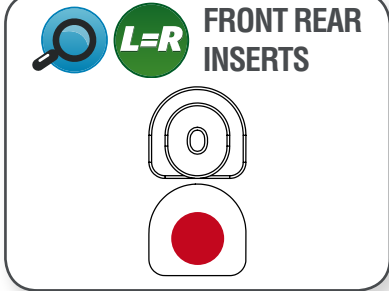

STEP 16

16.1

L=R



Tighten anti-roll bar cap until there is no play, and it moves freely.



16.2

L=R

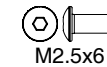

STEP 17

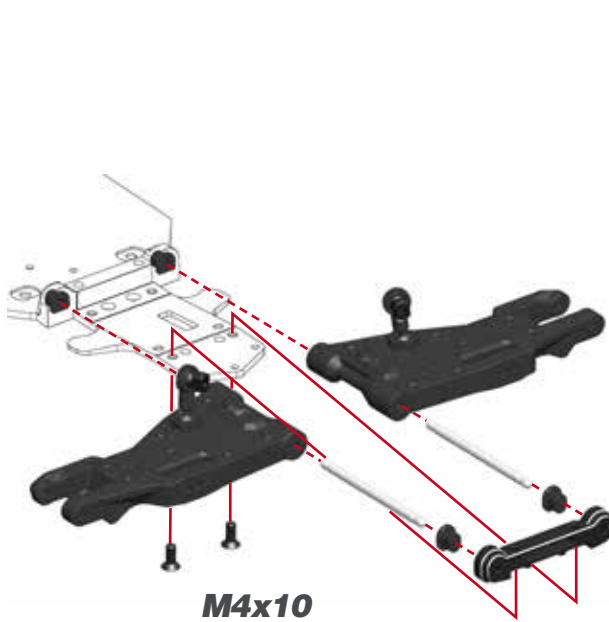

M4x10

 **L=R** FRONT SUSPENSION KICKUP INSERTS

9	9.5	10	10.5	11



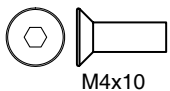

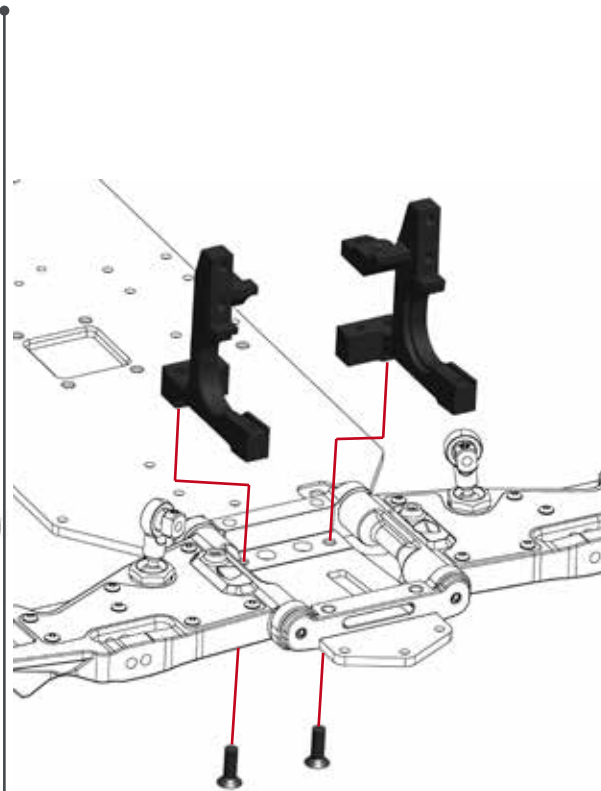

STEP 18

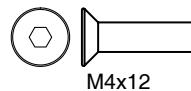

M4x12



STEP 19 **BAG 5**



 After building the differential with new gears, new differential case and bearings, the diff may feel a little tight. The connected parts need at least an hour run-time to create a perfect match. Attention: When you assemble the diff with too much initial play, the gears will not run-in properly and may wear quickly. After 1 or 2 hours of running the car, re-check the gear-mesh between the ring gear and the pinion. All parts should have run-in properly now. You may add or remove 8x11x0.1 shims as needed.

19.1

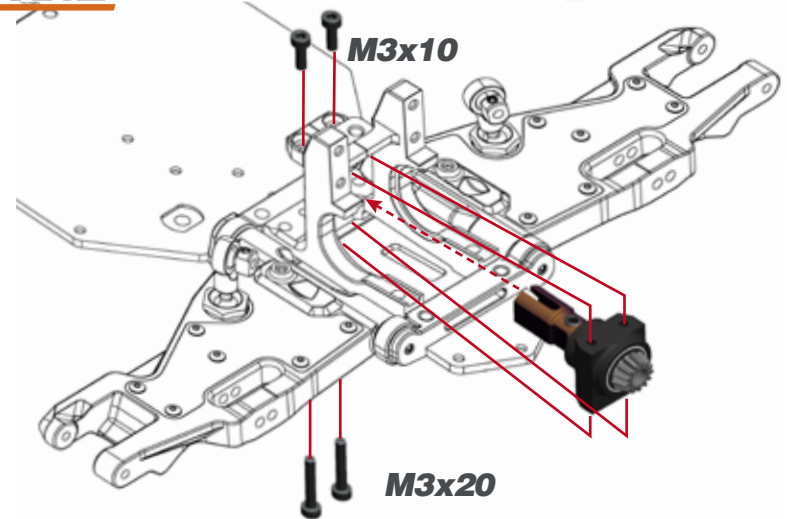

19.2



 **INDRIVE BRACKETS CHART**
Assemble the indrive bracket accordingly to the diff insert assert mounted in the step 18. 

	LOW		MID LOW		MID HIGH		HIGH
			NI		NI		

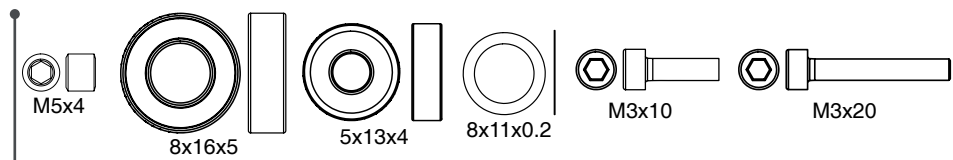



STEP 20

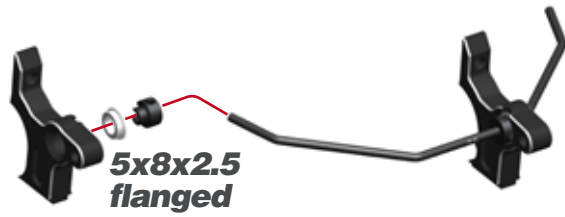

20.1

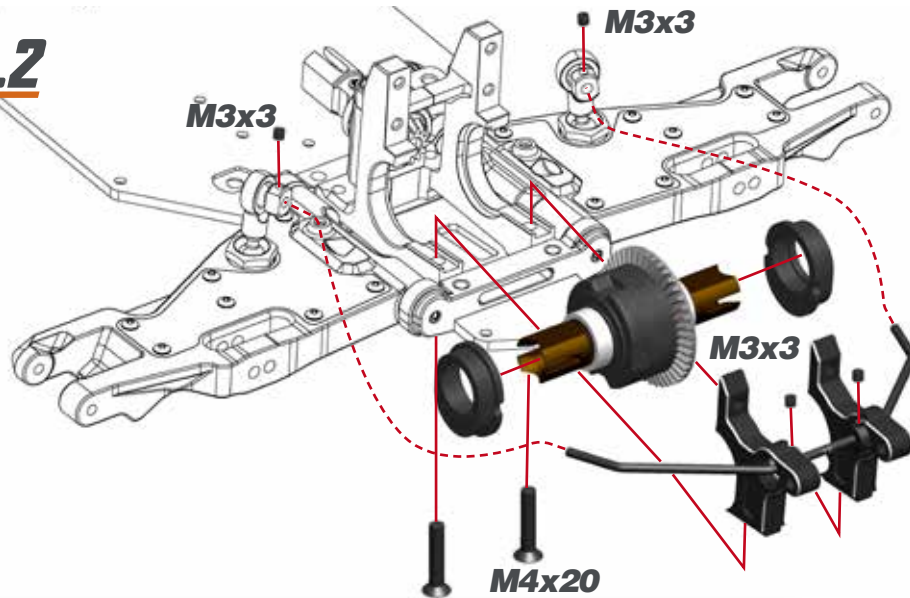

20.2

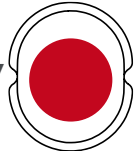

 **DIFF INSERTS CHART** 

	LOW		MID LOW		MID HIGH		HIGH
--	------------	---	----------------	---	-----------------	---	-------------



STEP 21

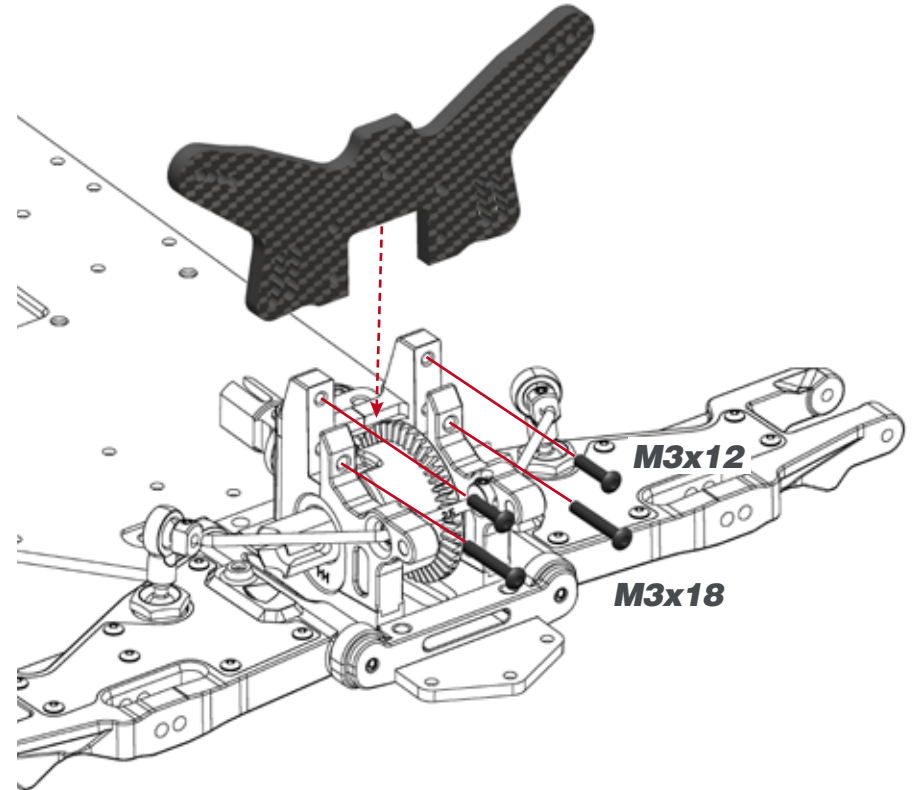

STEP 22 BAG 6

22.1 L=R

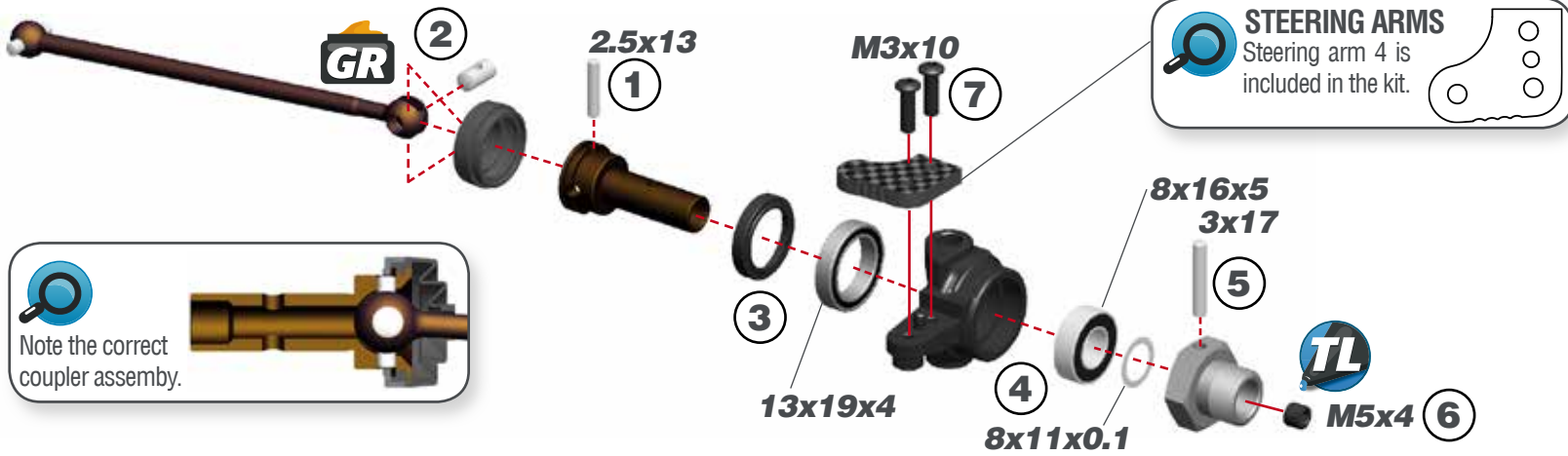

22.2

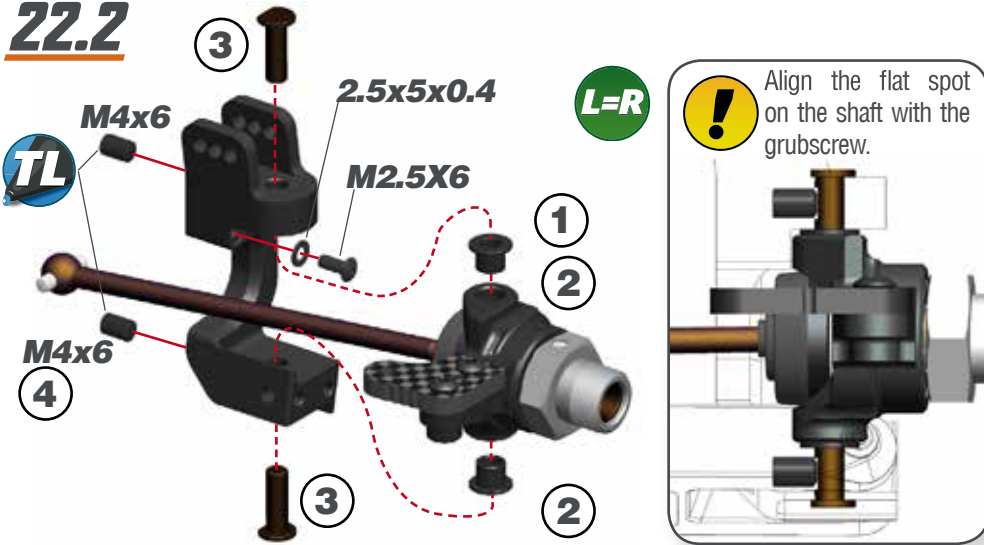

22.3

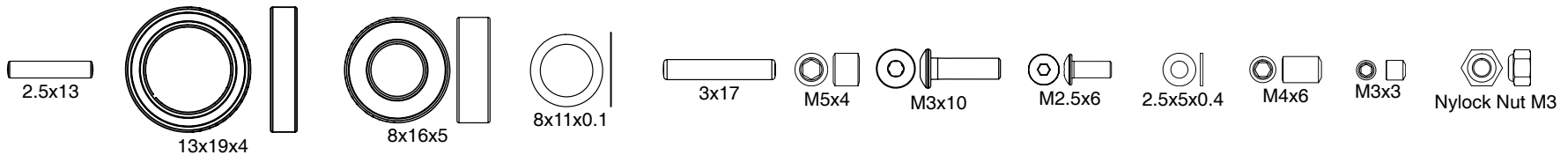
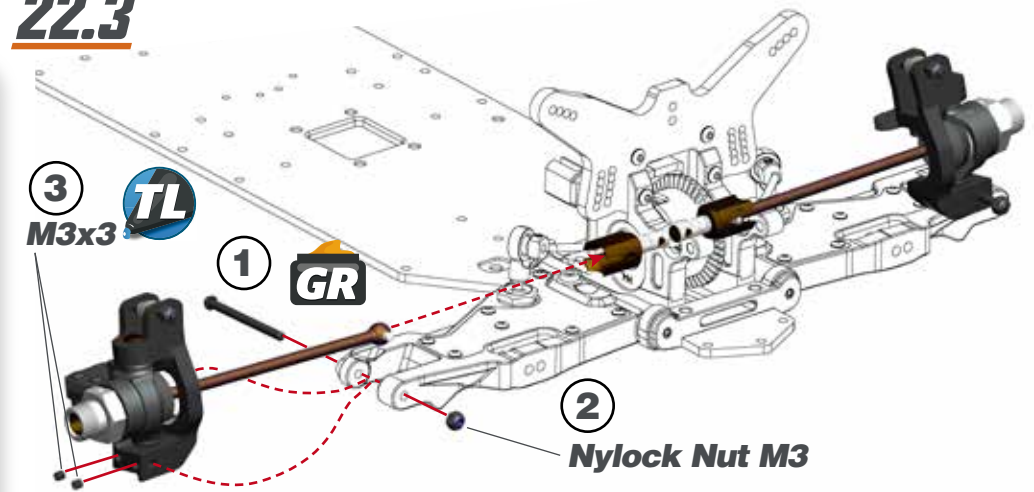

STEP 23

23.1

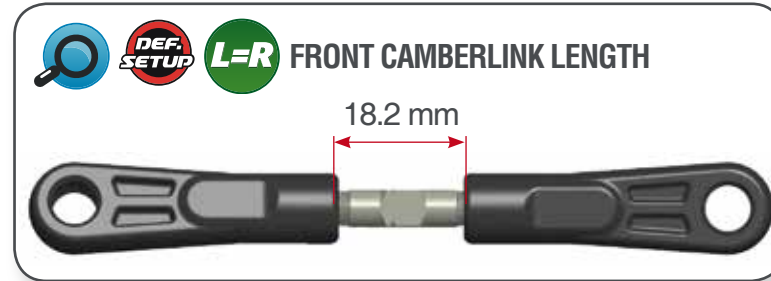

23.2

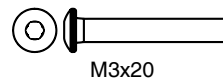
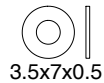
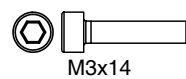
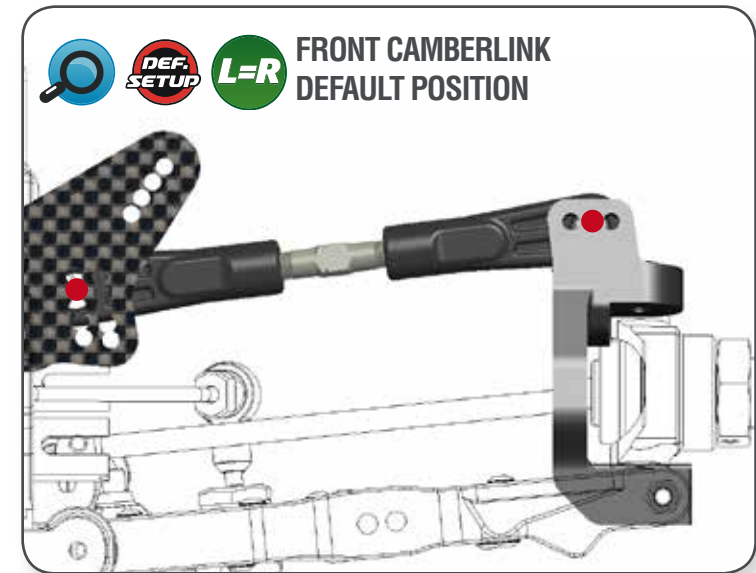
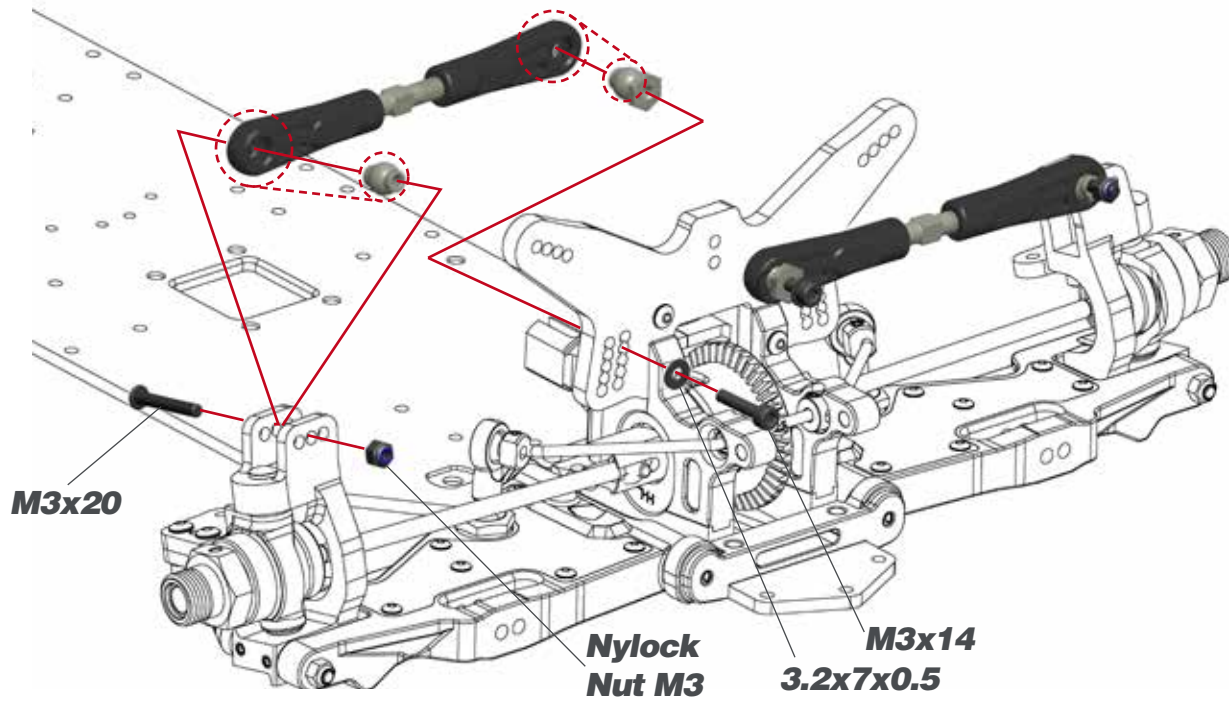

STEP 24 BAG 7

24.1



24.2

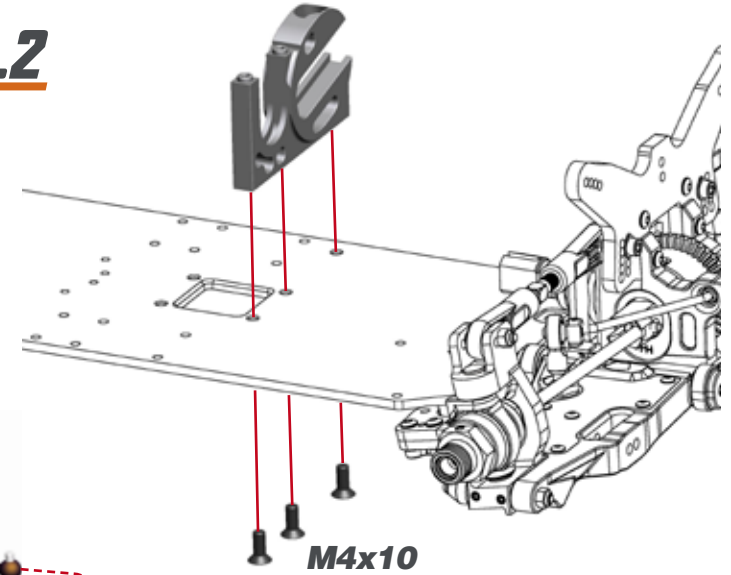

24.3

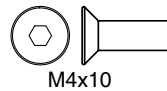
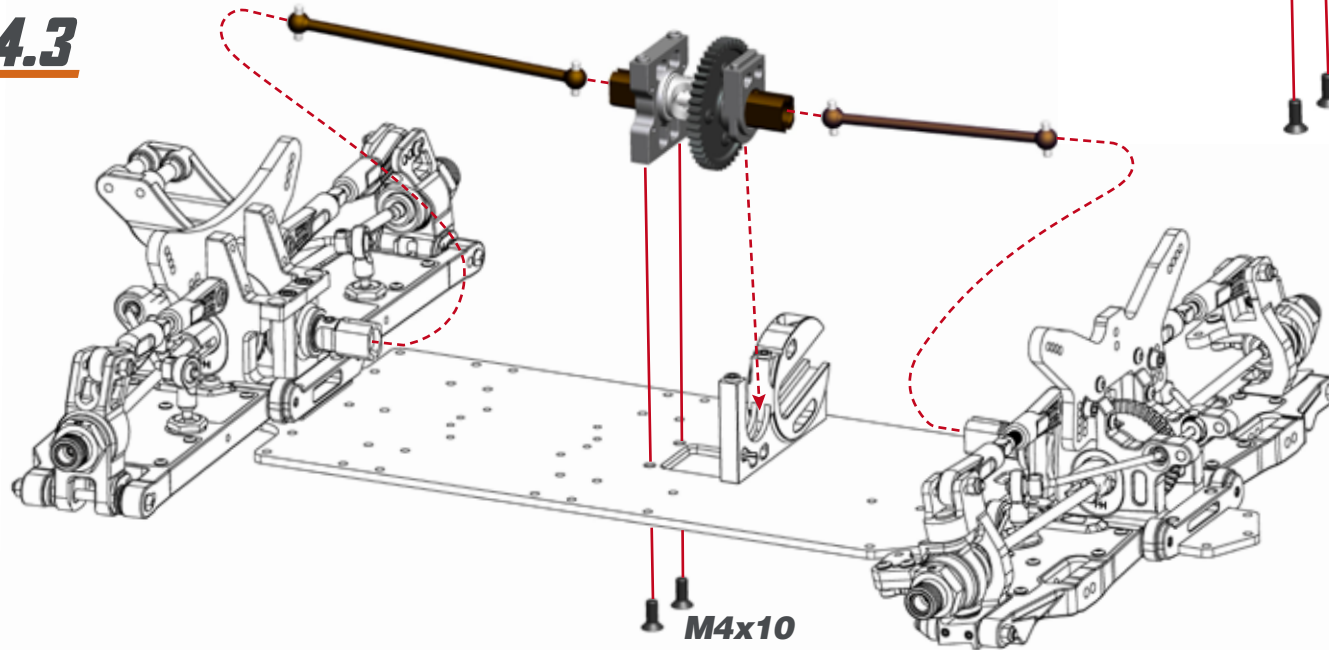

M4x10

STEP 25

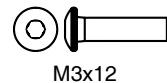
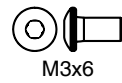
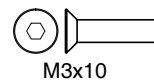
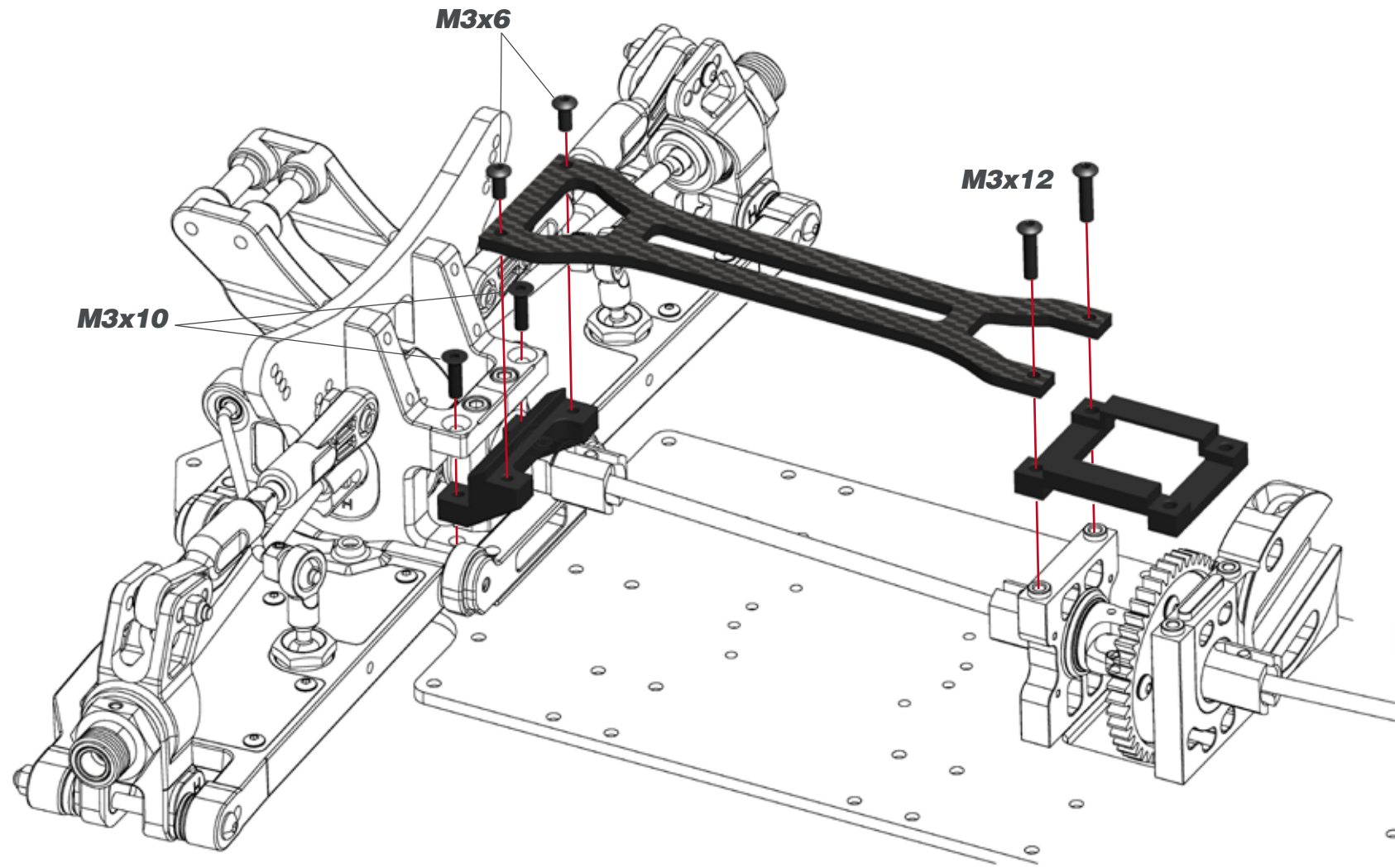

STEP 26 BAG 8

26.1



26.2

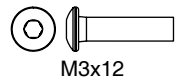
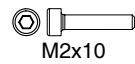

 The servo saver spring should be preloaded 4.5mm. Also notice the correct orientation of the collar.

STEP 27

27.1



STEERING TRACKROD LENGTH

  



27.2

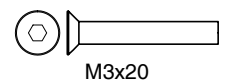
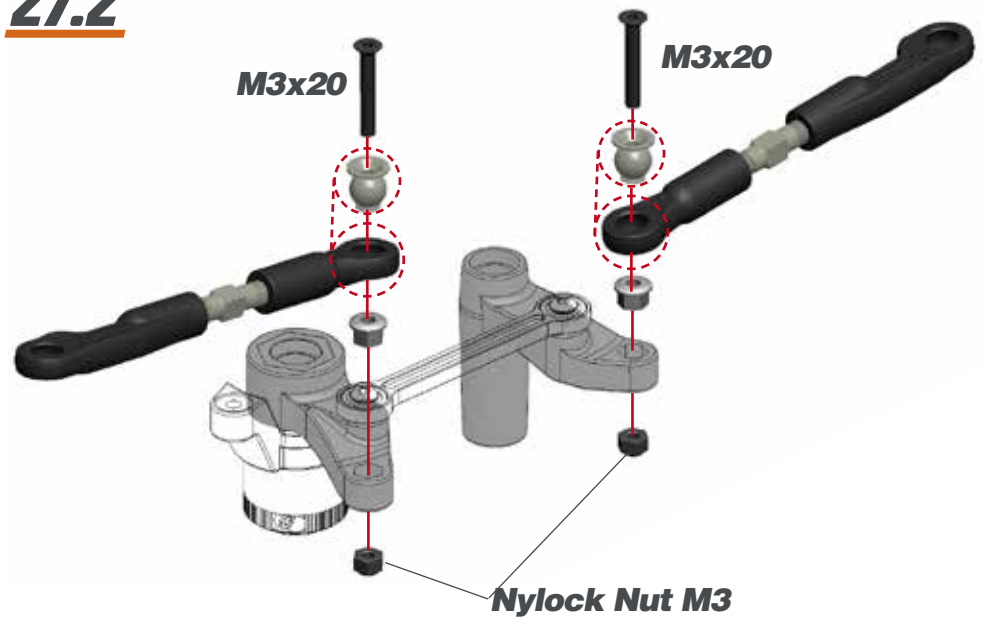

STEP 28

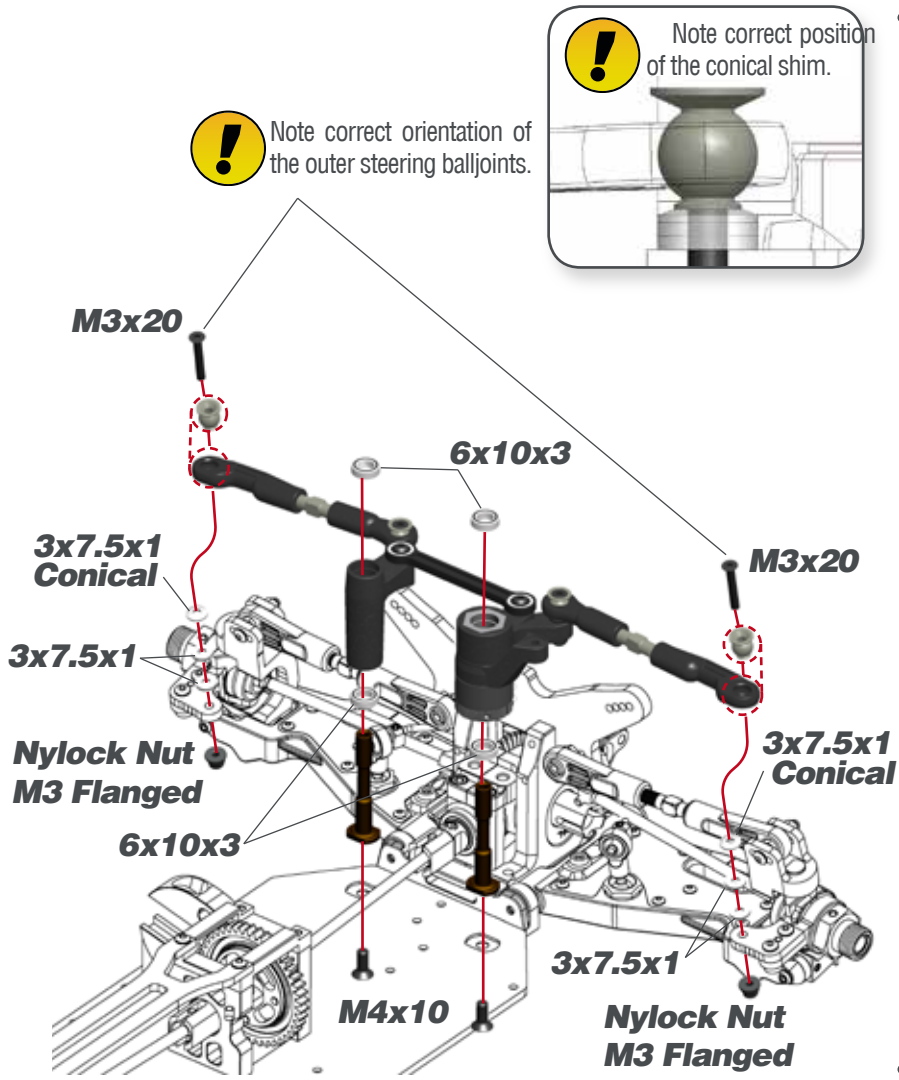

STEP 29

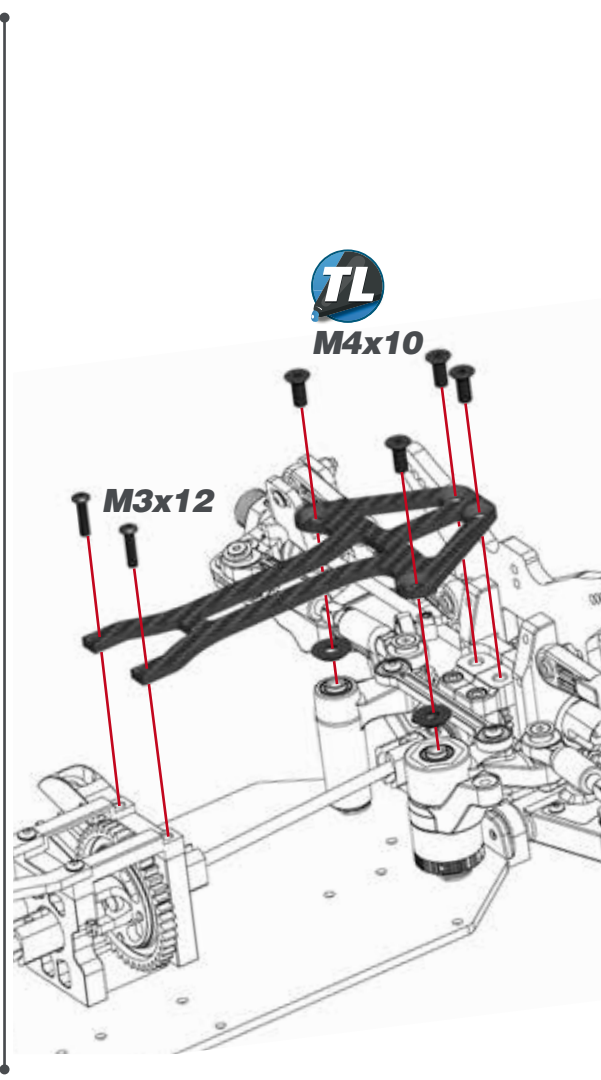

STEP 30 BAG 9

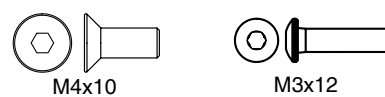
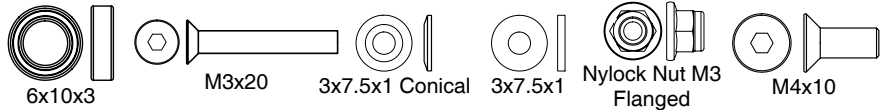
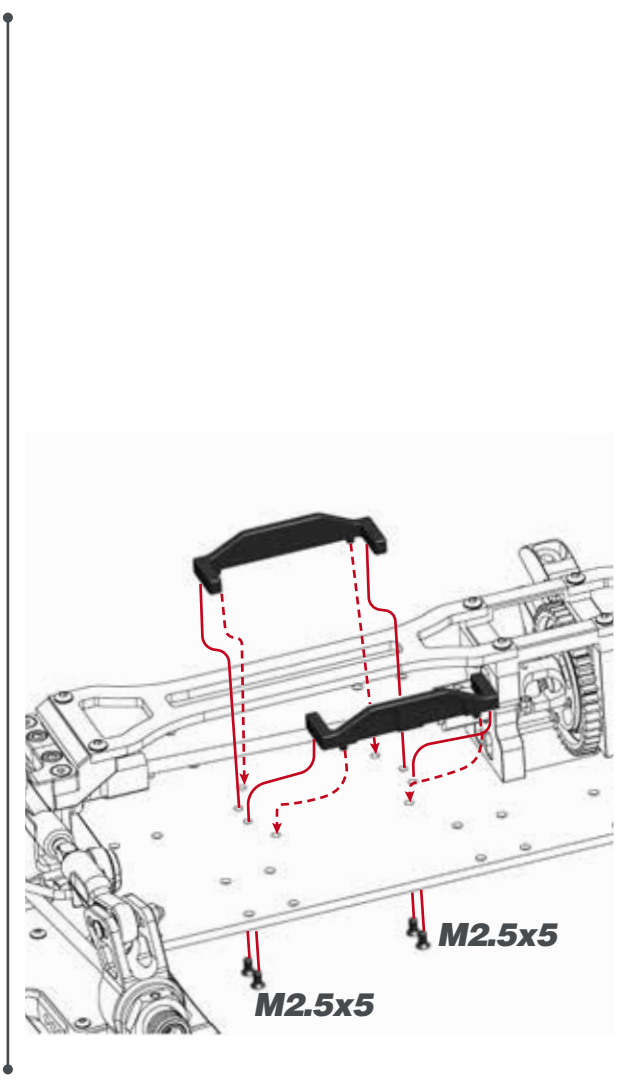

STEP 31

31.1

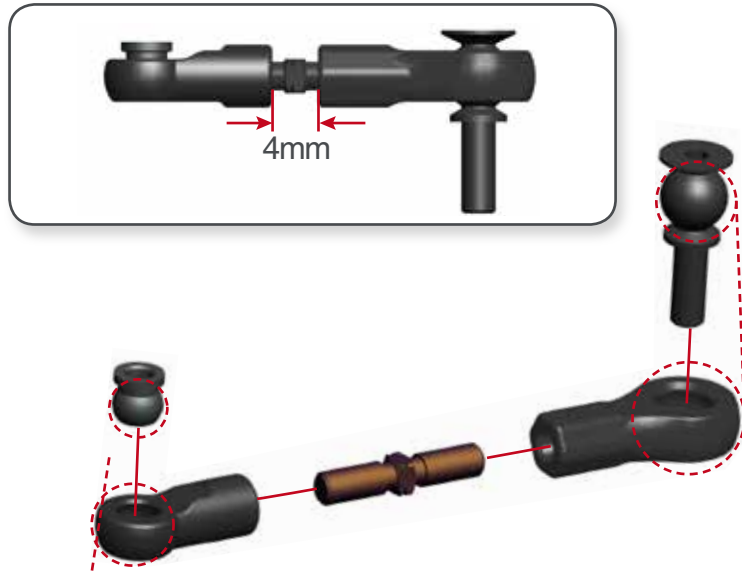

31.2

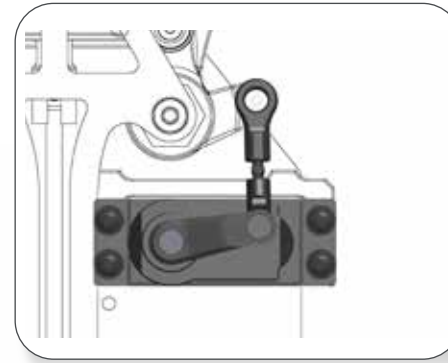
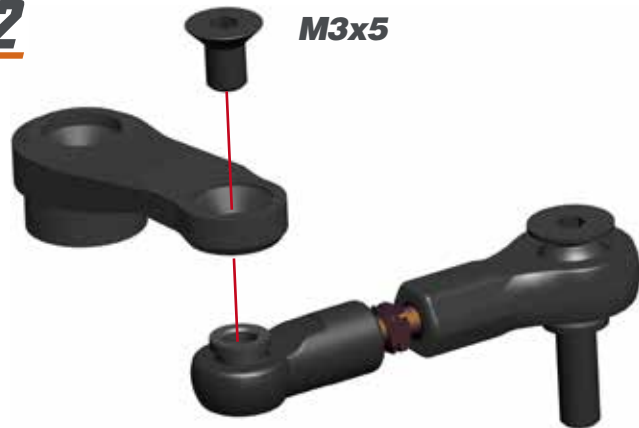

31.3

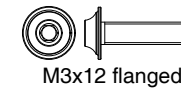
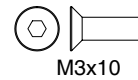
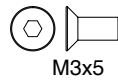
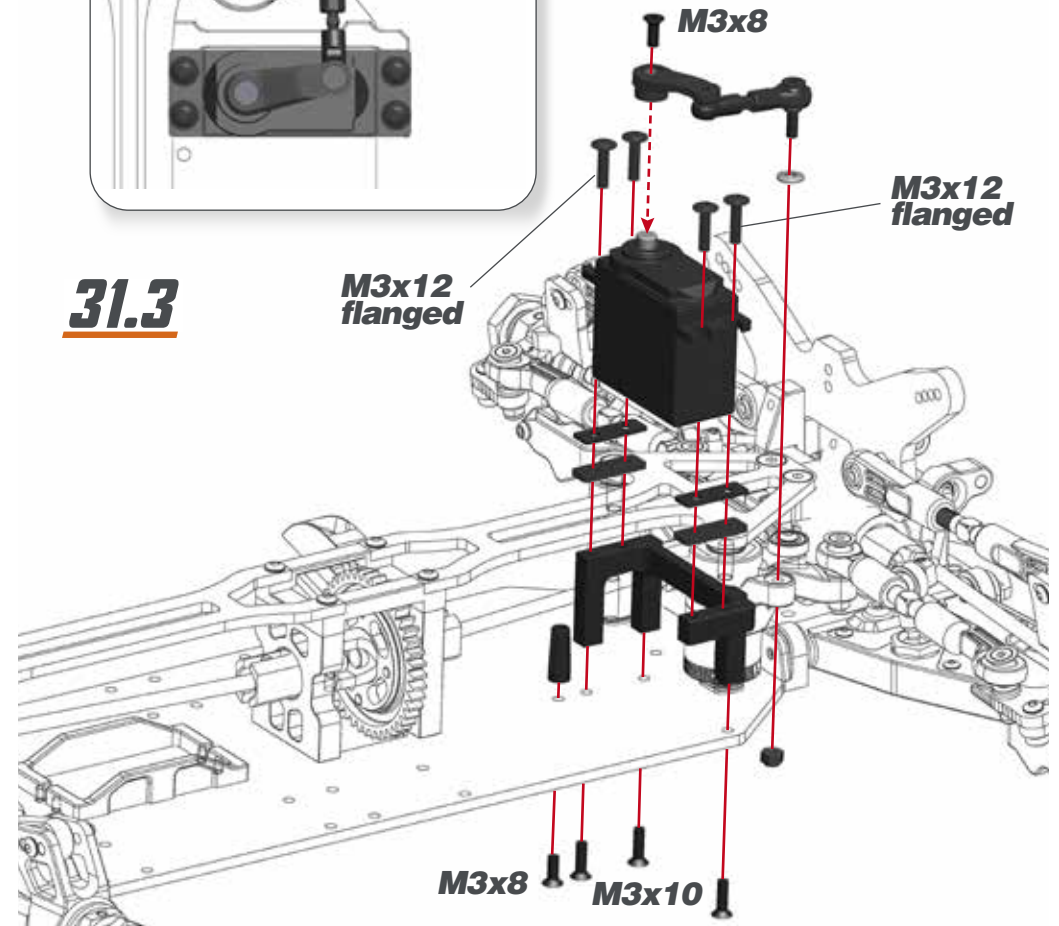

STEP 32

32.1



Pinion is not included in the kit. Assemble the proper pinion for your set-up.

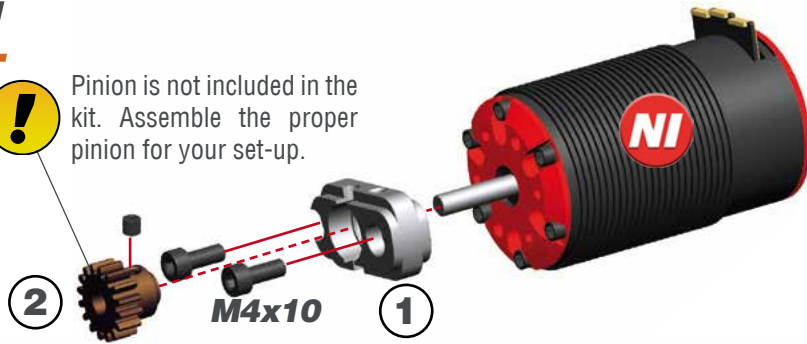

32.2

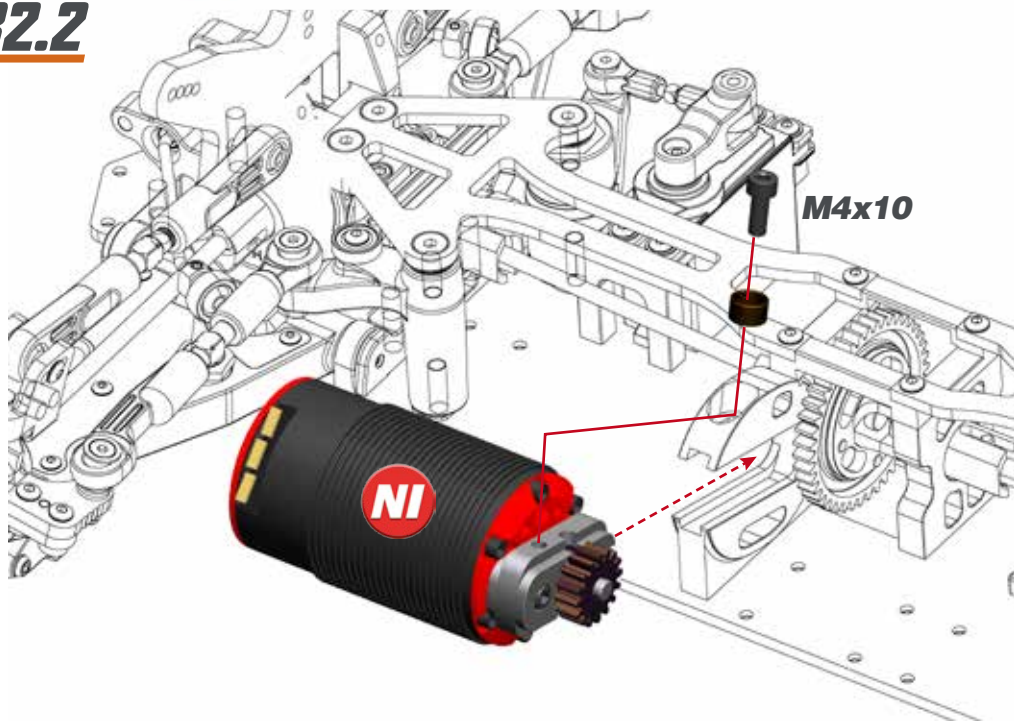

M4x10

STEP 33

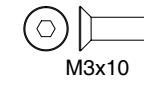
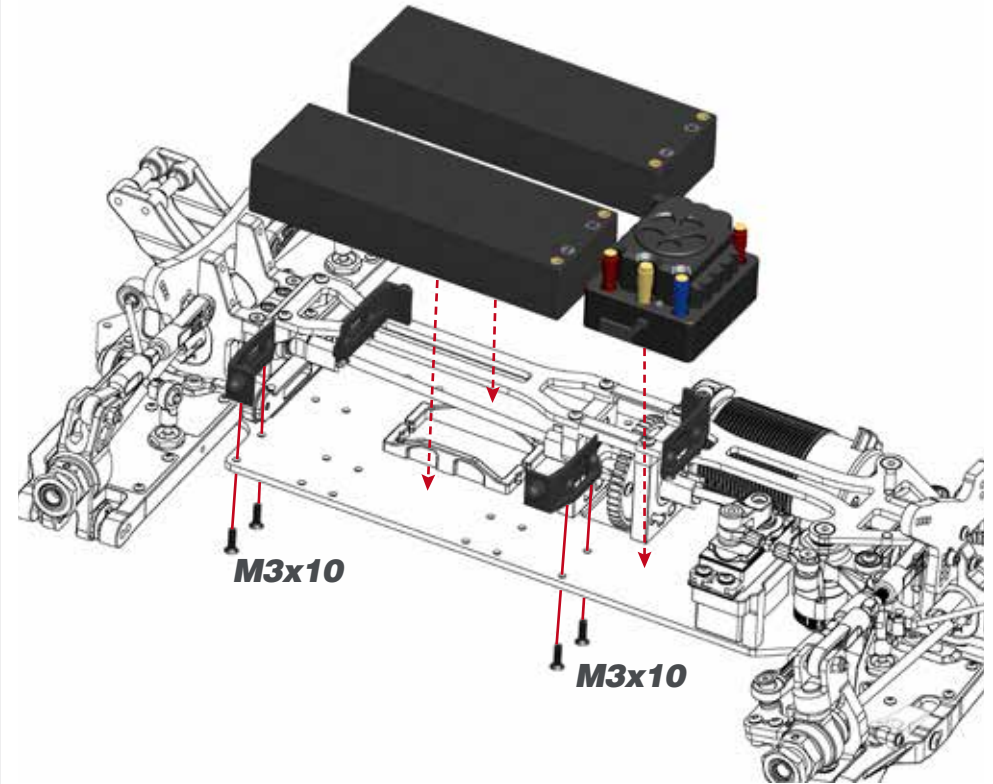

M3x10

STEP 34 SHOCK BAG

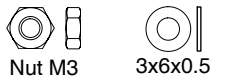
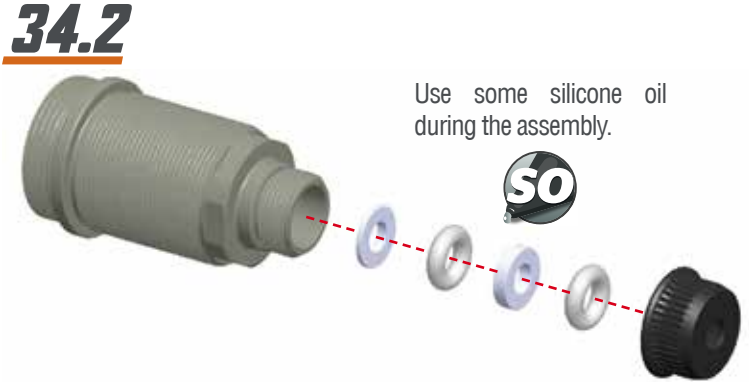

STEP 35

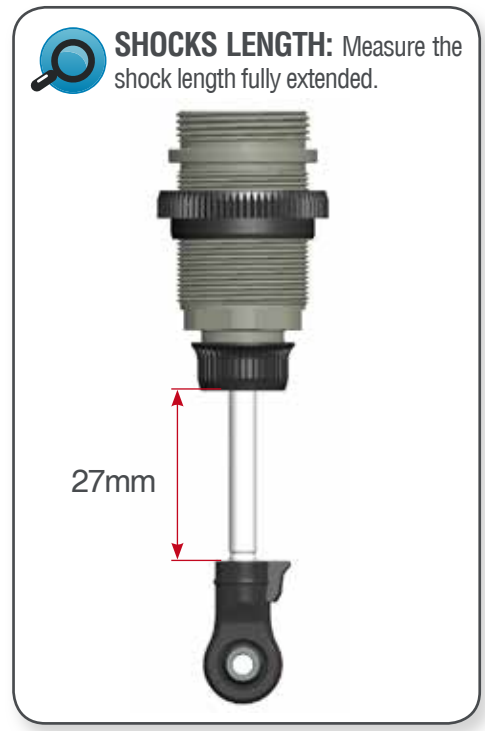
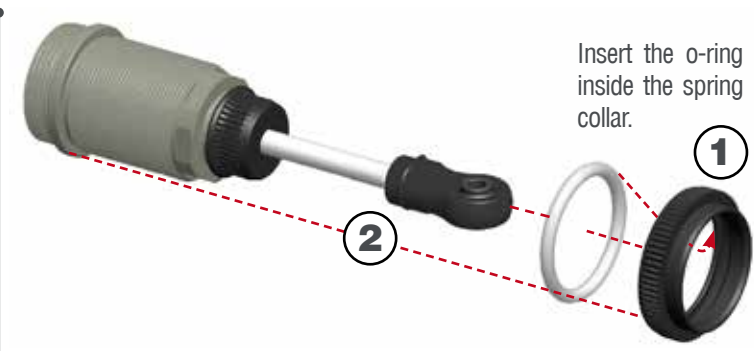

STEP 36

- 1- Fill up with silicone oil fully using the silicone oil supplied in the kit. For the correct cst value please check the default setupsheet.
- 2- Extend the shockrod fully
- 3- Move the shockrod slowly up and down to let ALL air bubbles escape.



STEP 37

37.1

Push the membrane into the shock cap.



38.2

Close top step by step only 3/4



STEP 38

1-Bleed: push the shock-rod all the way in slowly, to allow excessive oil to escape.

2- With shockrod fully in, close fullu the shock cap.



STEP 39

Assemble the spring and spring-cup (align correctly) to complete the shock.

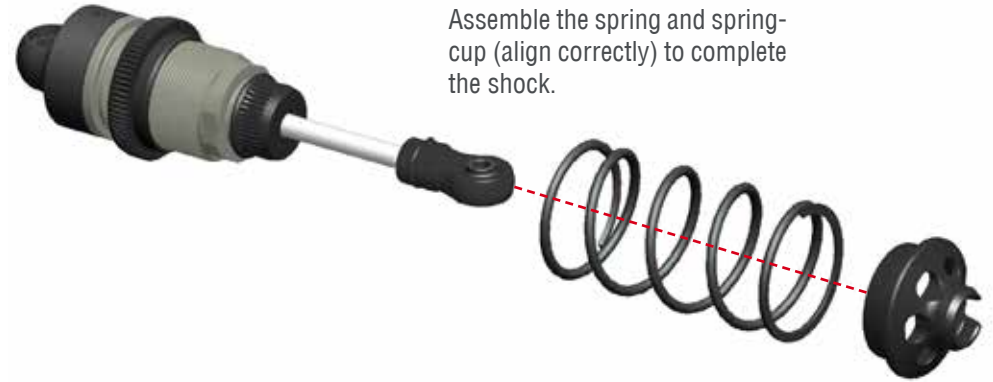

STEP 40

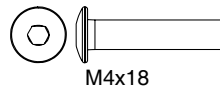
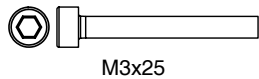
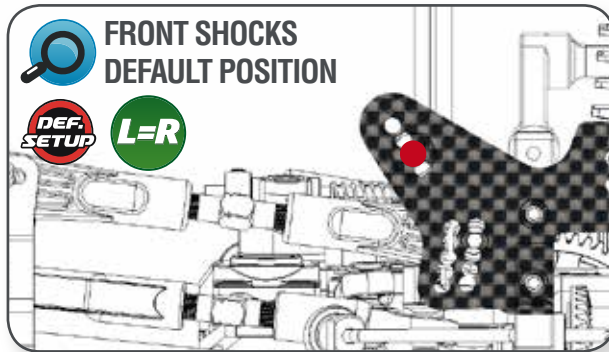
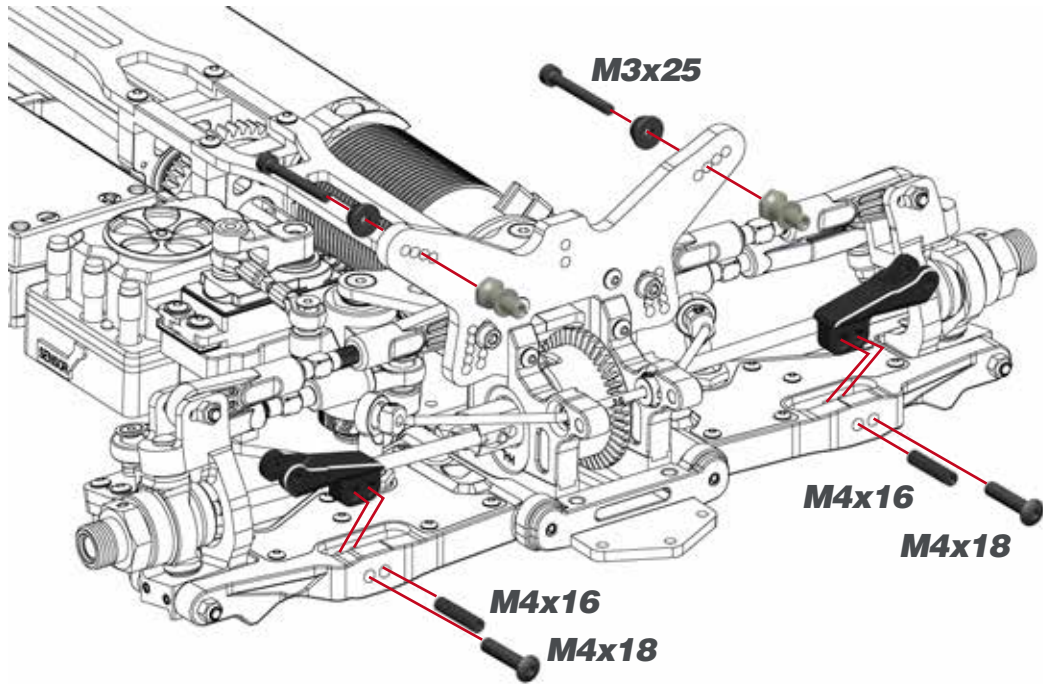

STEP 41

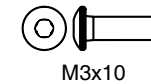
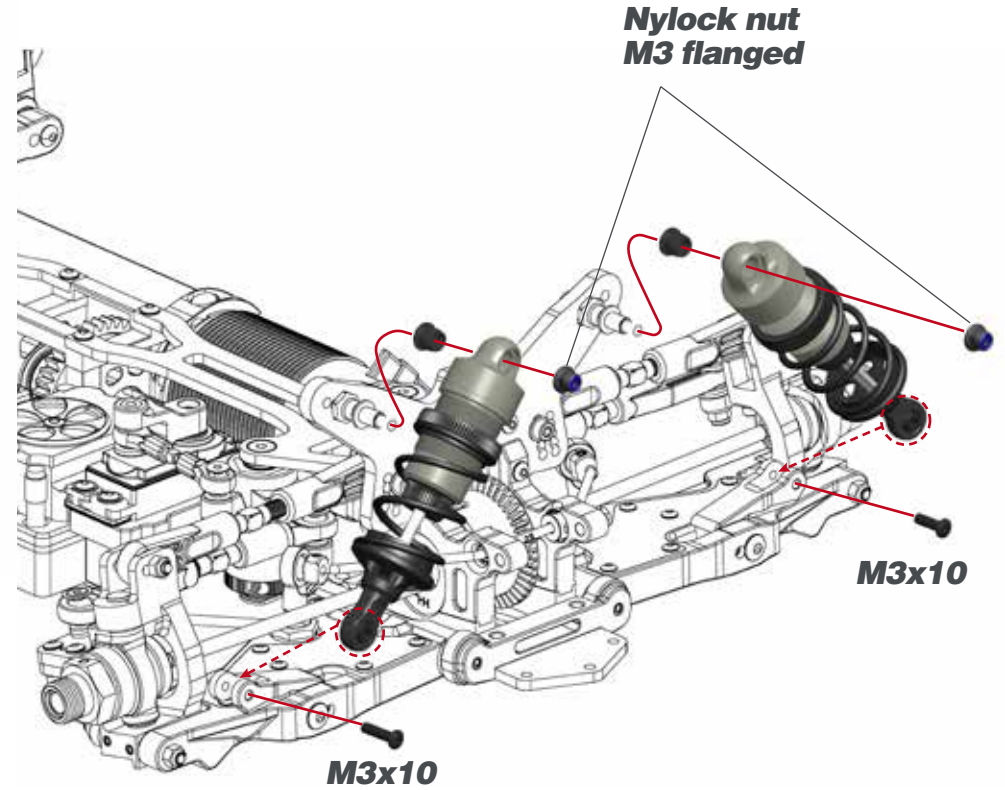

STEP 42

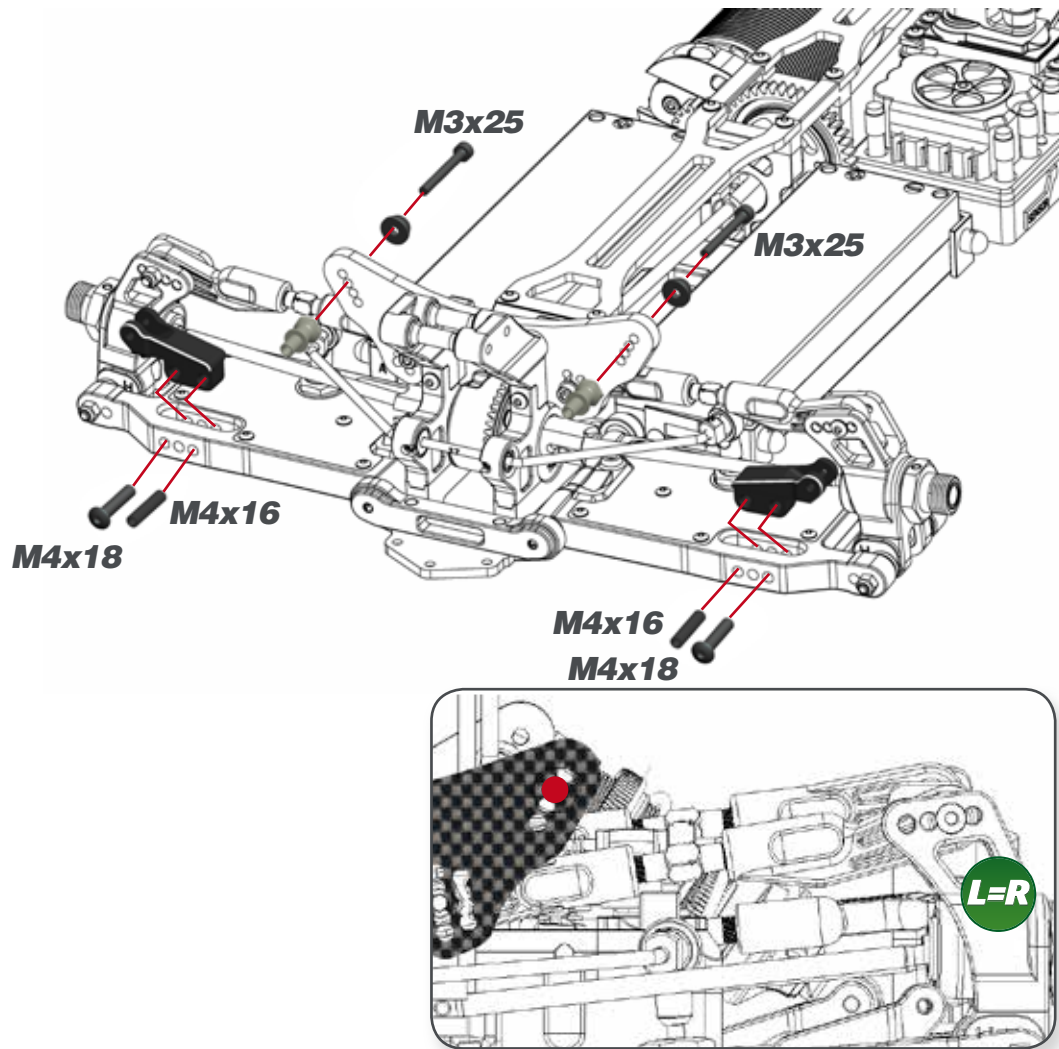

STEP 43

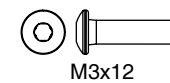
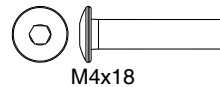
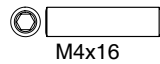
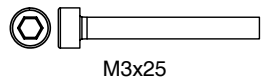
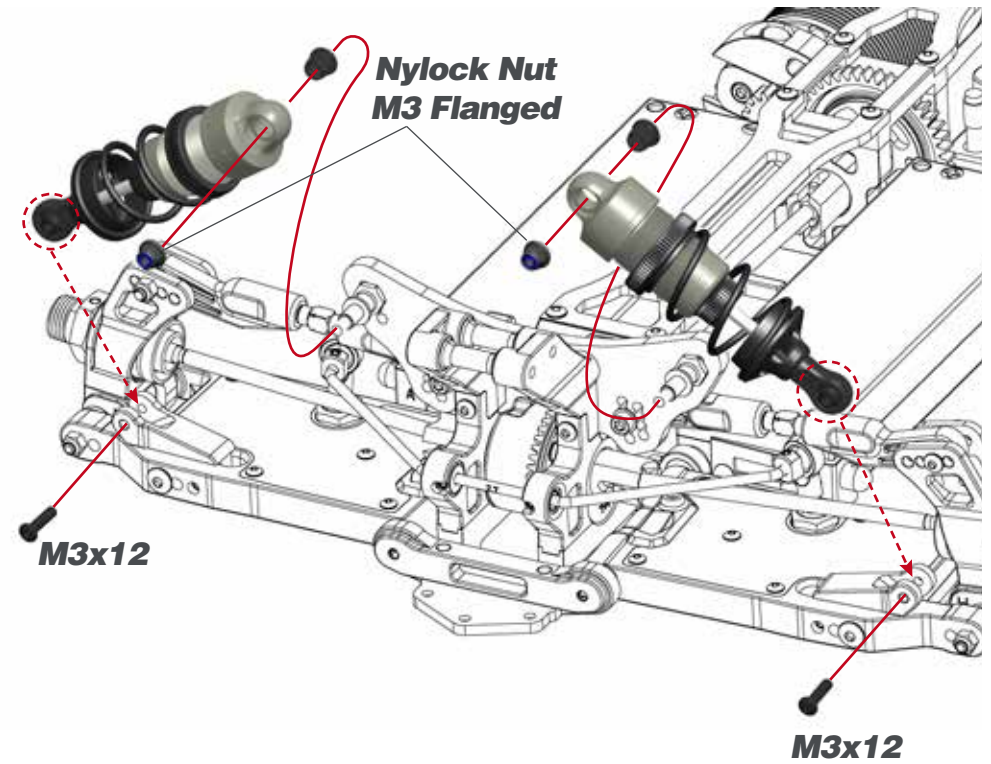

STEP 44 BAG 18

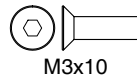
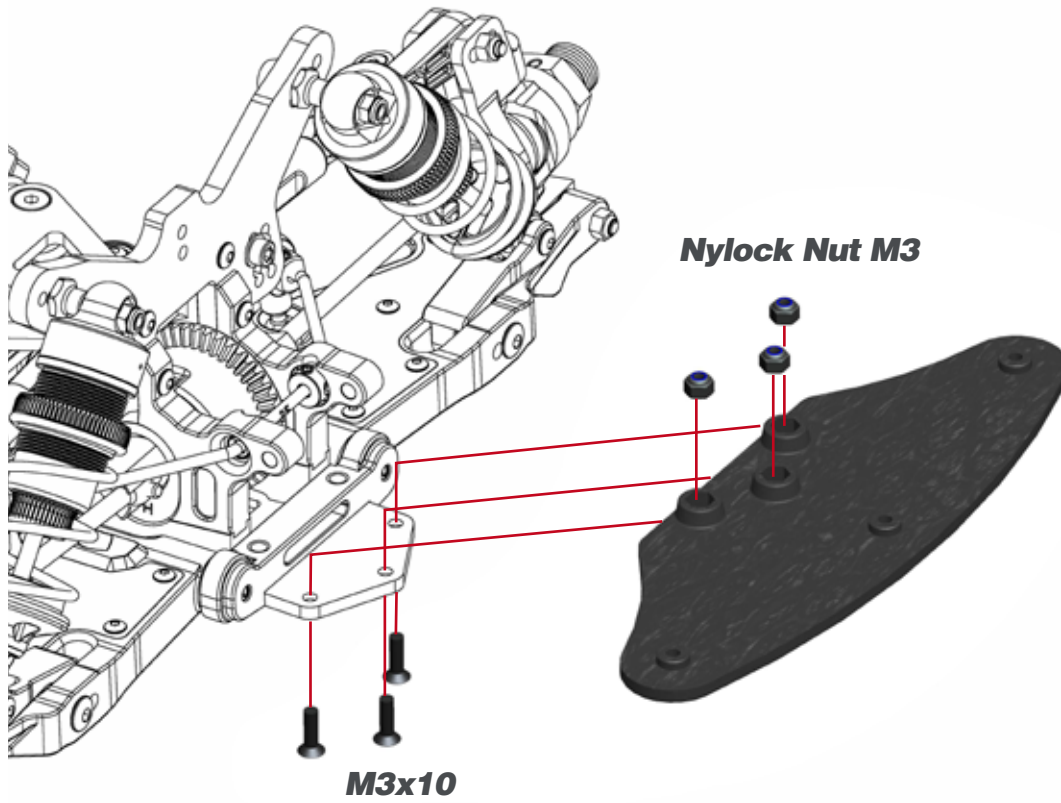

M3x10



Nylock Nut M3

STEP 45

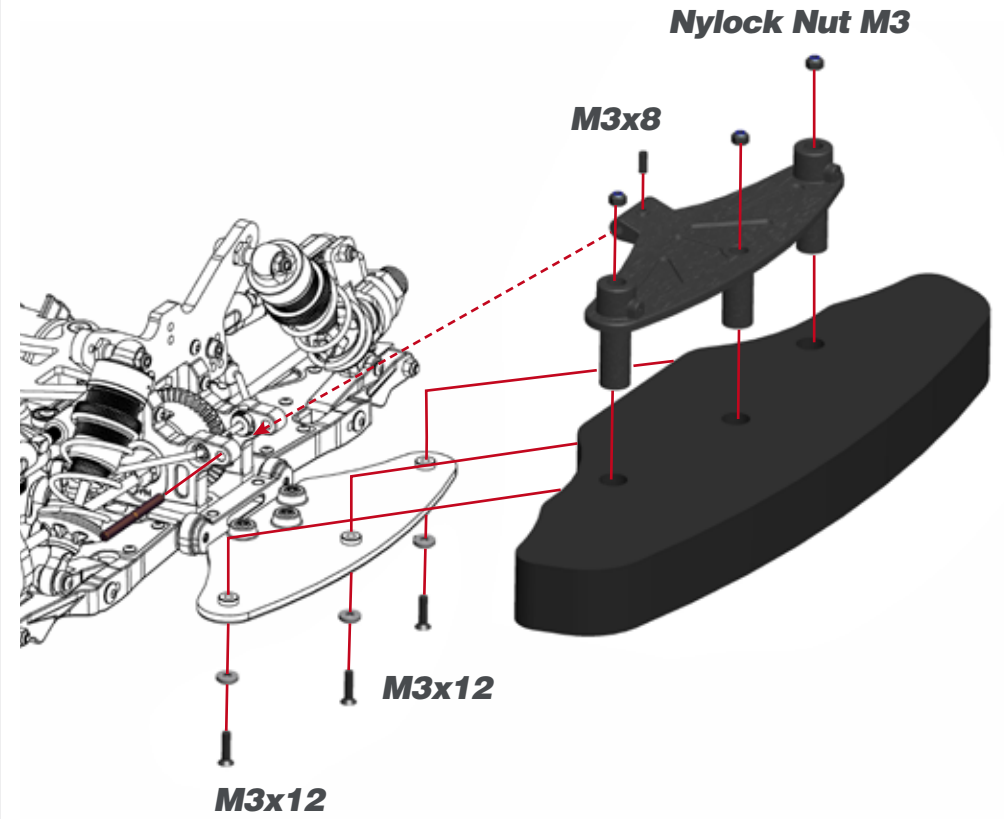

M3x8



M3x12



Nylock Nut M3

STEP 46

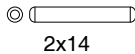
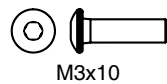
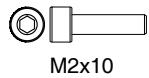
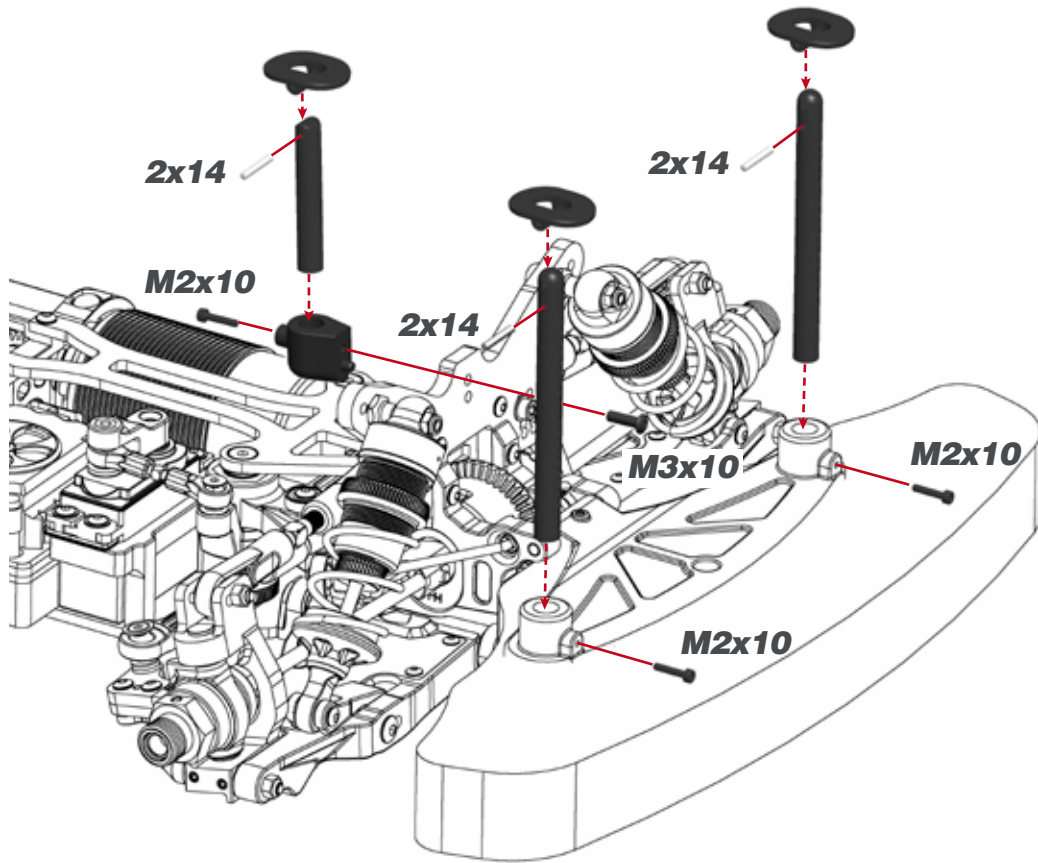

STEP 47 BAG 11

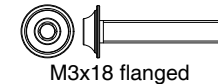
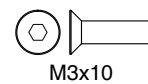
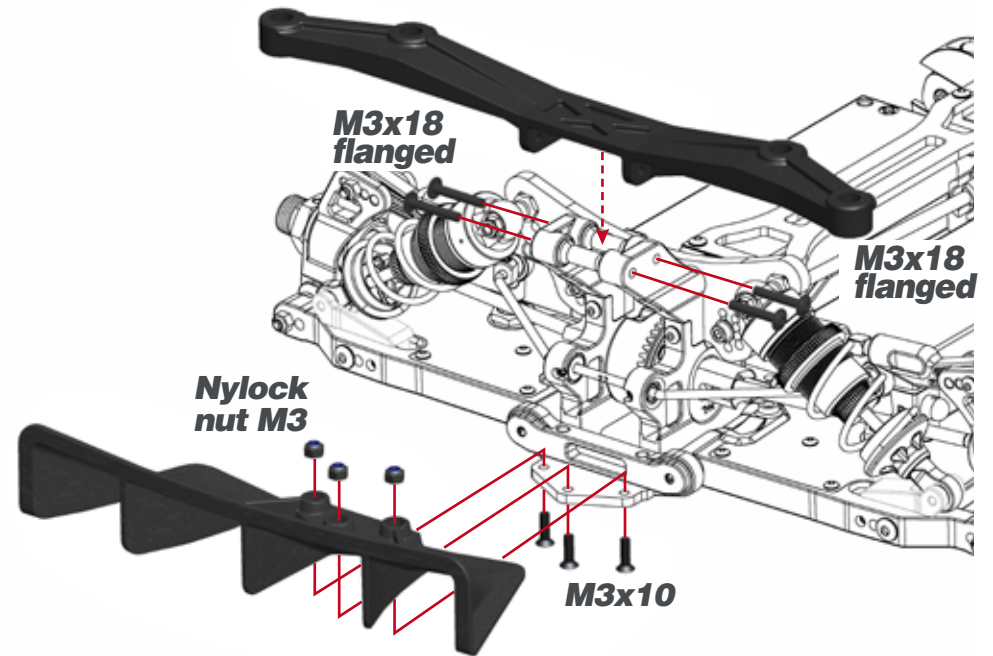

STEP 48

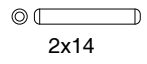
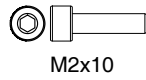
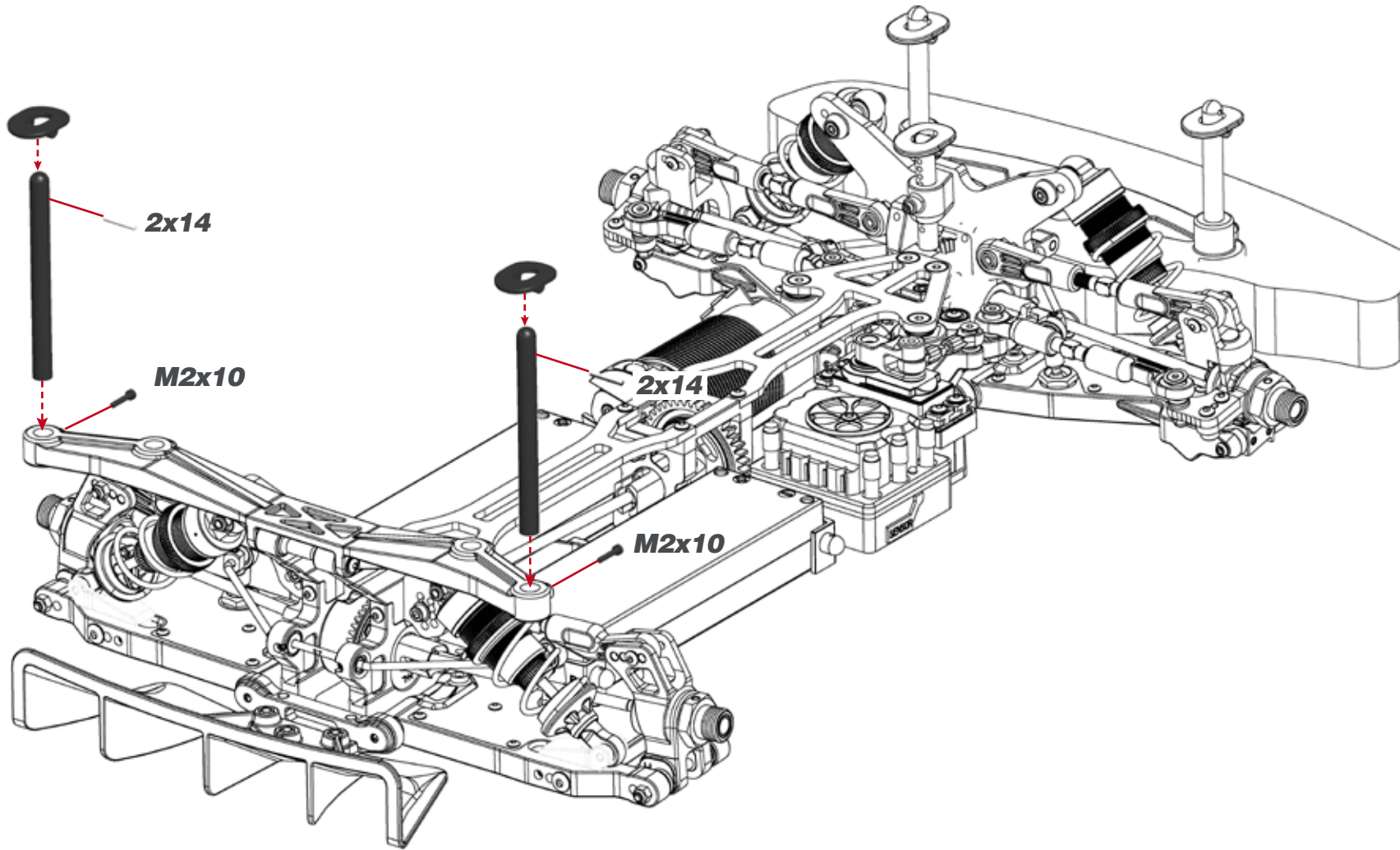

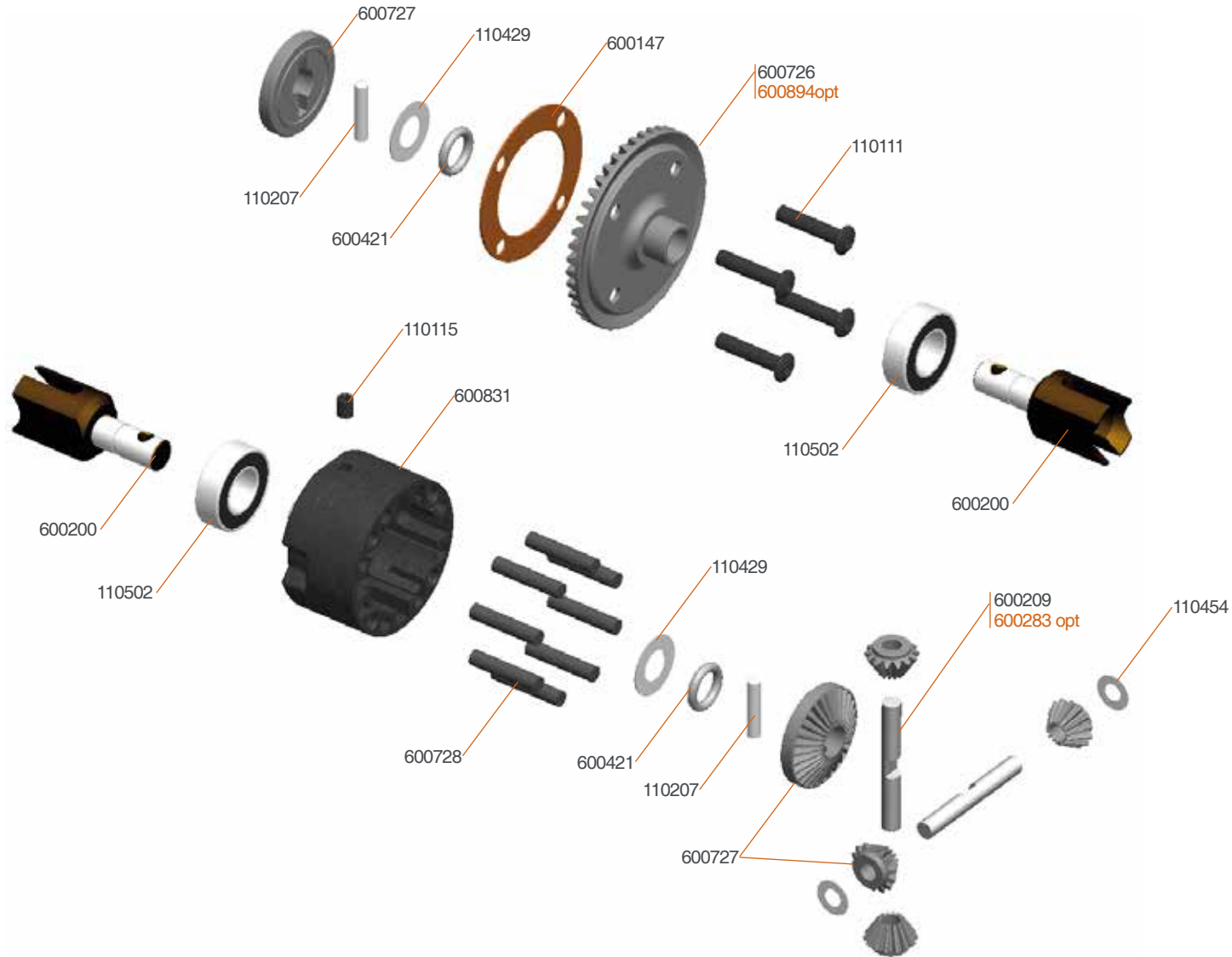

- OPT** 600894 Overdrive diff gear 43T SRX8
- 600868 Diff set 44T front / rear SRX8
- 600283 Diff pin 10T alu (2)

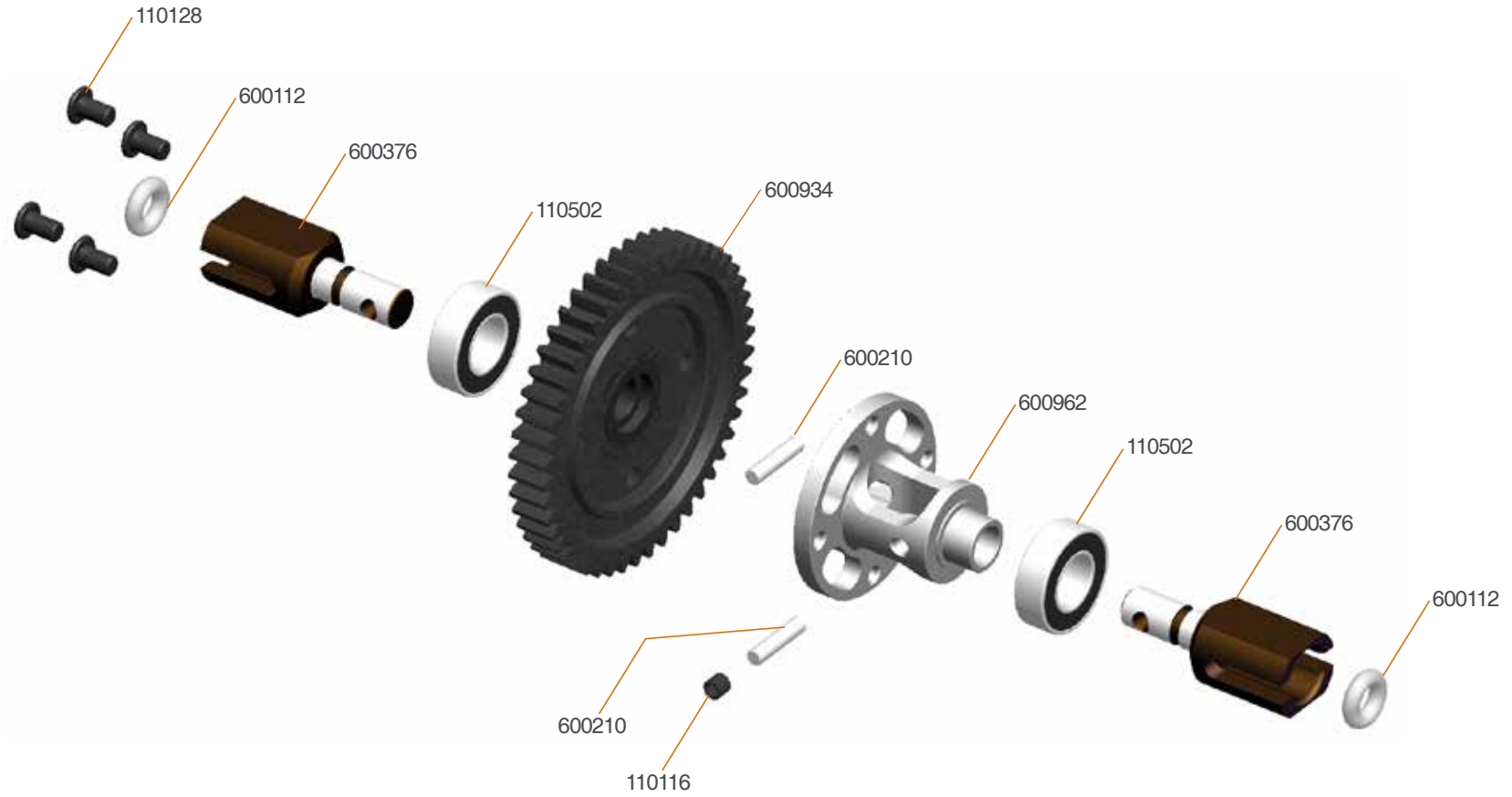

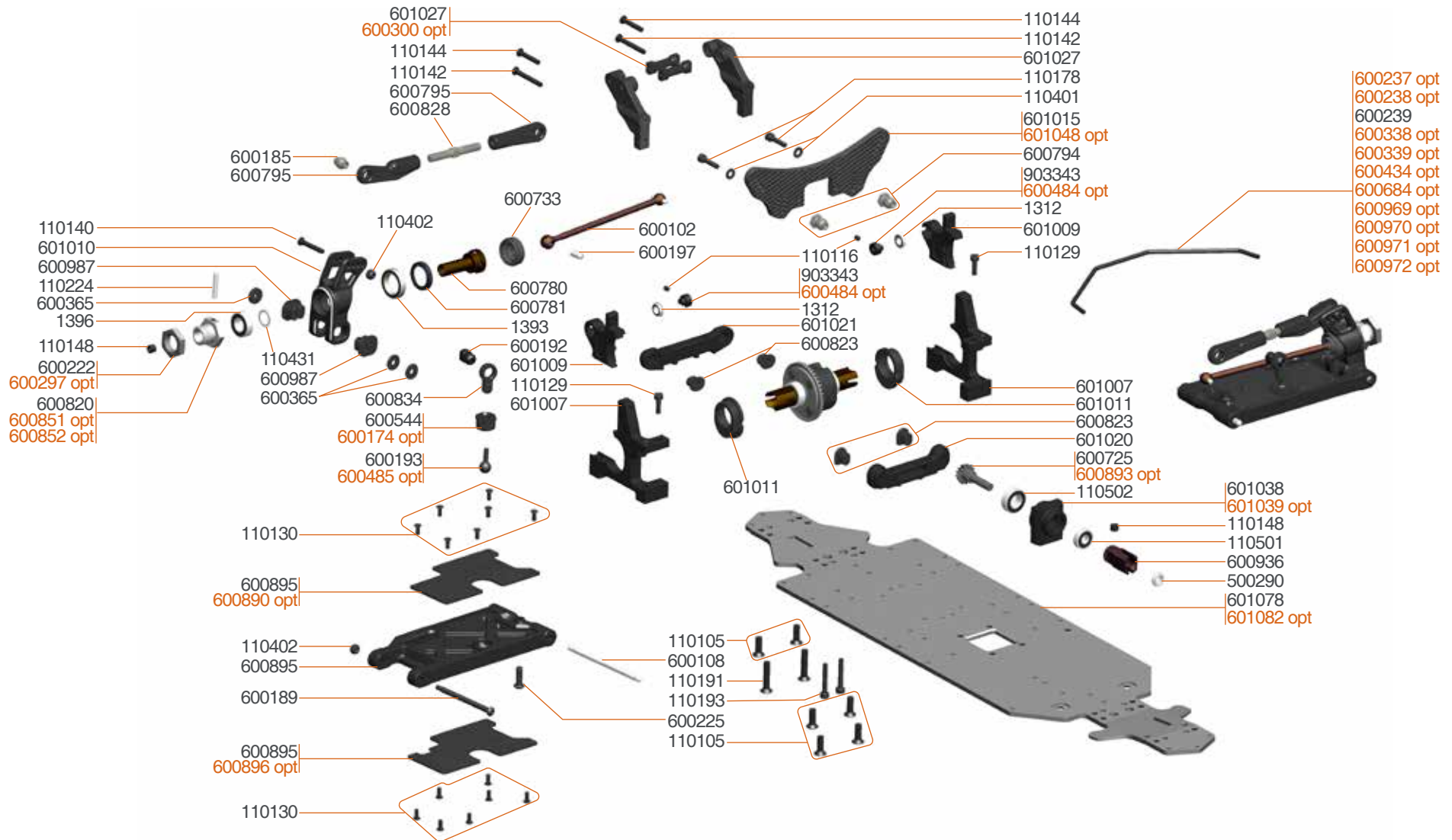

- 600174 Antirollbar nut (2)
- 600300 Post wingmount alu (2)
- 600338 Antiroll bar rear 1.8mm
- 600339 Antiroll bar rear 2.0mm
- 600434 Antiroll bar rear 2.4mm
- 600237 Antiroll bar rear 2.3mm
- 600238 Antiroll bar rear 2.5mm

- 600684 Antiroll bar rear 3.0mm
- 600484 Antirollbar spacer 3mm alu (2)
- 600485 Pivotball threaded anti roll bar alu (2)
- 600896 Wishbone insert carbon RR Lower V2 SRX8
- 600851 Wheelhexagon 0mm light (2) SRX8
- 600852 Wheelhexagon +1mm light (2) SRX8
- 600890 Wishbone insert carbon RR Upper SRX8 (2)

- 600893 Overdrive diff pinion 13T SRX8
- 600969 Antiroll bar rear 2.2 mm
- 600970 Antiroll bar rear 2.4 mm
- 600971 Antiroll bar rear 2.6 mm
- 600972 Antiroll bar rear 2.8 mm
- 600297 Wheelnut light 17mm (4)

- 601048 Shock Tower RR Straight arm SRX8-GT
- 601082 Chassis alu SRX8 GTE LWB
- 601085 Upright riser HT SRX8 GT



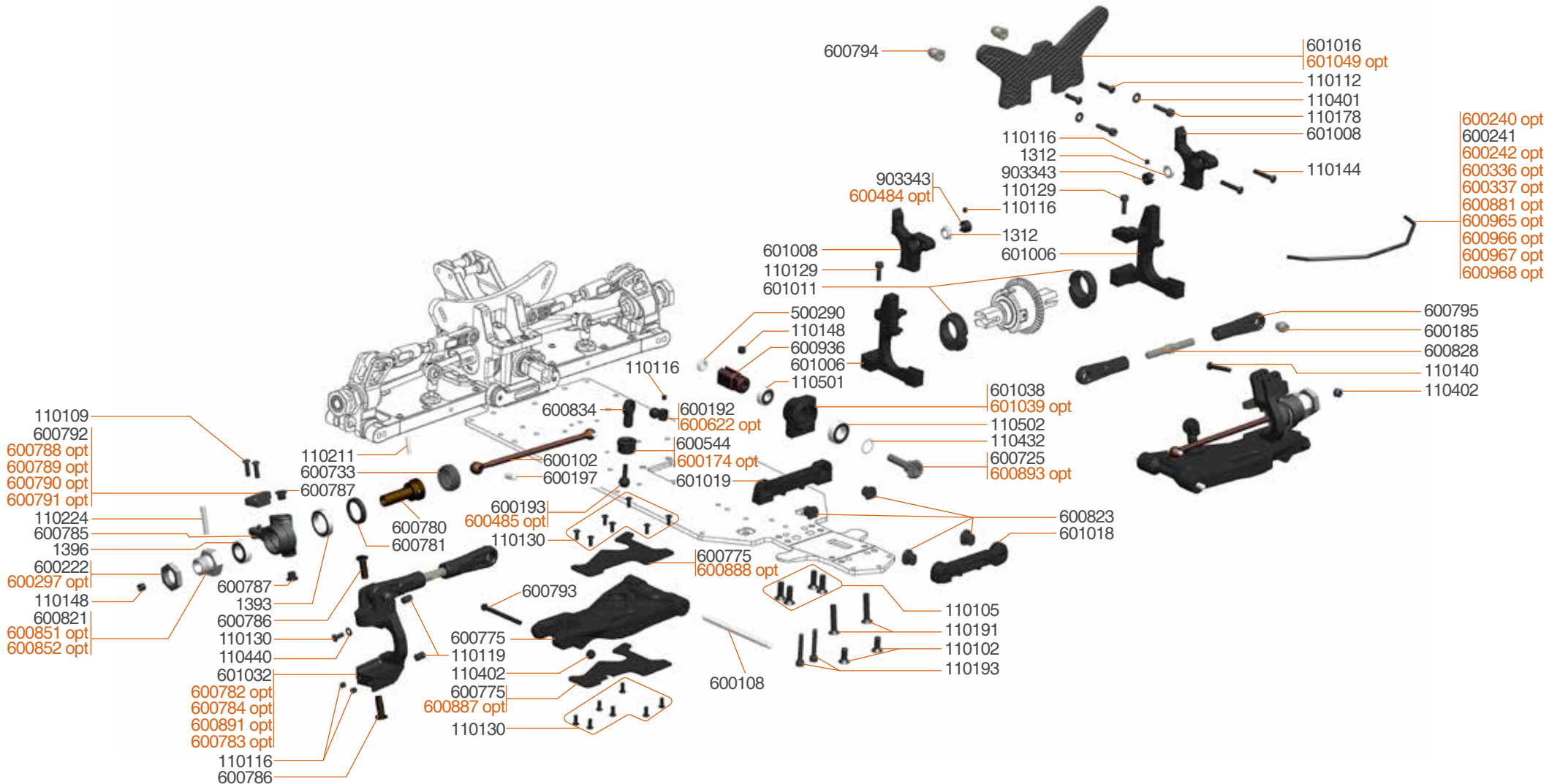

- 600139 Pinion mount alu M SRX8 GT
- 600174 Antirollbar nut (2)
- 600336 Antiroll bar front 1.8mm
- 600337 Antiroll bar front 2.0mm
- 600240 Antiroll bar front 2.3mm
- 600242 Antiroll bar front 2.7mm
- 600297 Wheelnut light 17mm (4)

- 600484 Antirollbar spacer alu (2)
- 600485 Pivotball threaded anti roll bar alu (2)
- 600622 Pivotball antirollbar alu (4)
- 600782 C-hub 13deg L+R alu SRX8
- 600783 C-hub 15deg L+R alu SRX8
- 600784 C-hub 17deg L+R alu SRX8
- 600788 Steering arm 0 carbon (2) SRX8
- 600789 Steering arm 1 carbon (2) SRX8

- 600851 Wheelhexagon 0mm light (2) SRX8
- 600852 Wheelhexagon +1mm light (2) SRX8
- 600881 Antiroll bar front 3.0 mm
- 600887 Wishbone insert carbon FR Lower
- 600888 Wishbone insert carbon FR Upper
- 600790 Steering arm 2 carbon (2) SRX8
- 600791 Steering arm 3 carbon (2) SRX8

- 600891 C-hub 19deg L+R alu SRX8
- 600893 Overdrive diff pinion 13T SRX8
- 600965 Antiroll bar front 2.2 mm
- 600966 Antiroll bar front 2.4 mm
- 600967 Antiroll bar front 2.6 mm
- 600968 Antiroll bar front 2.8 mm
- 601049 Shock Tower FR Straight arm SRX8

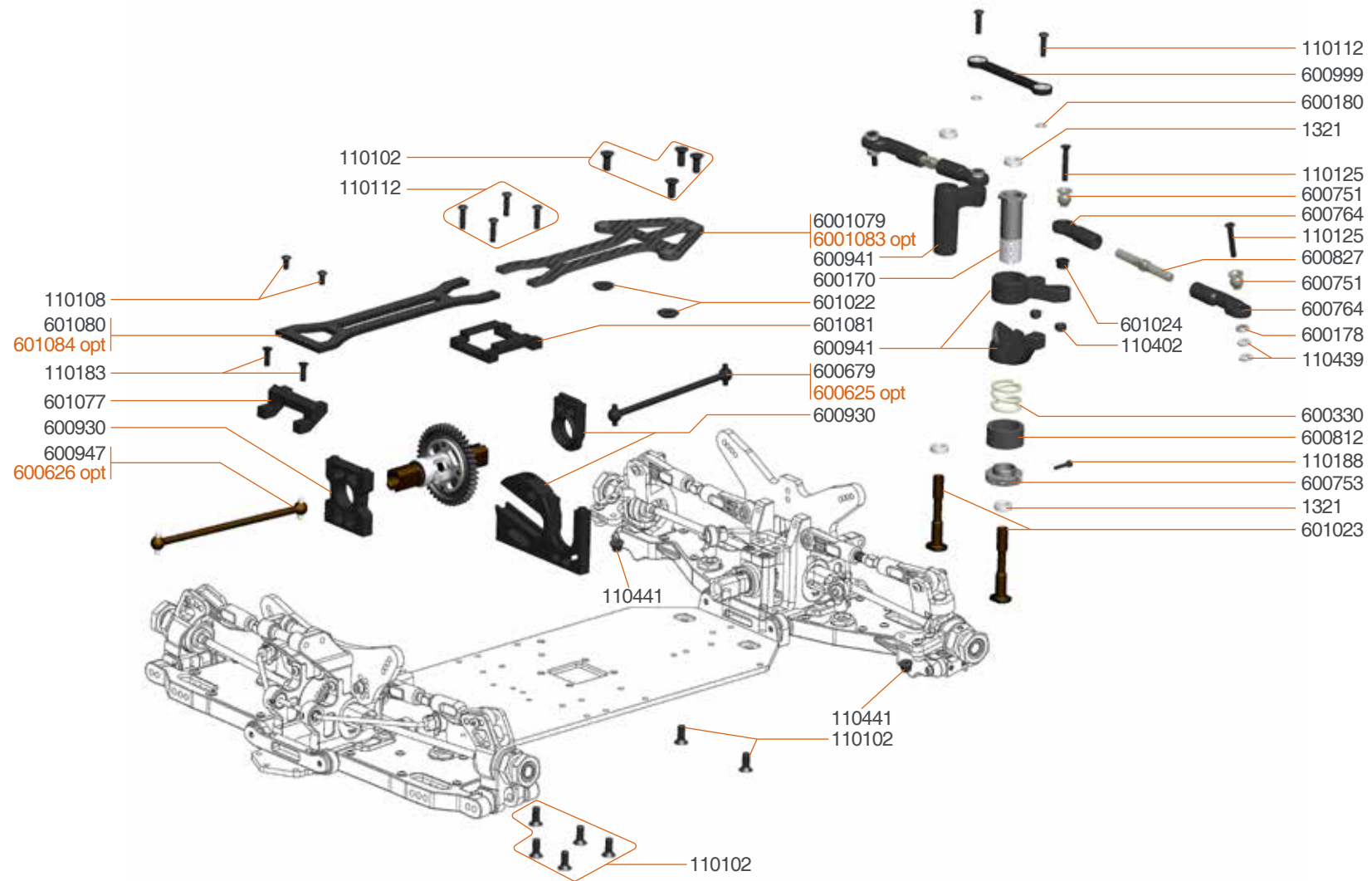

- 601083 Topdeck fr carbon SRX8 GTE LWB
- 601084 Topdeck rr carbon SRX8 GTE LWB
- 600625 Driveshaft center RR 811 E-S
- 600626 Driveshaft center FR 811 E-S
- 601086 Conversion set SRX GTE SWB to LWB

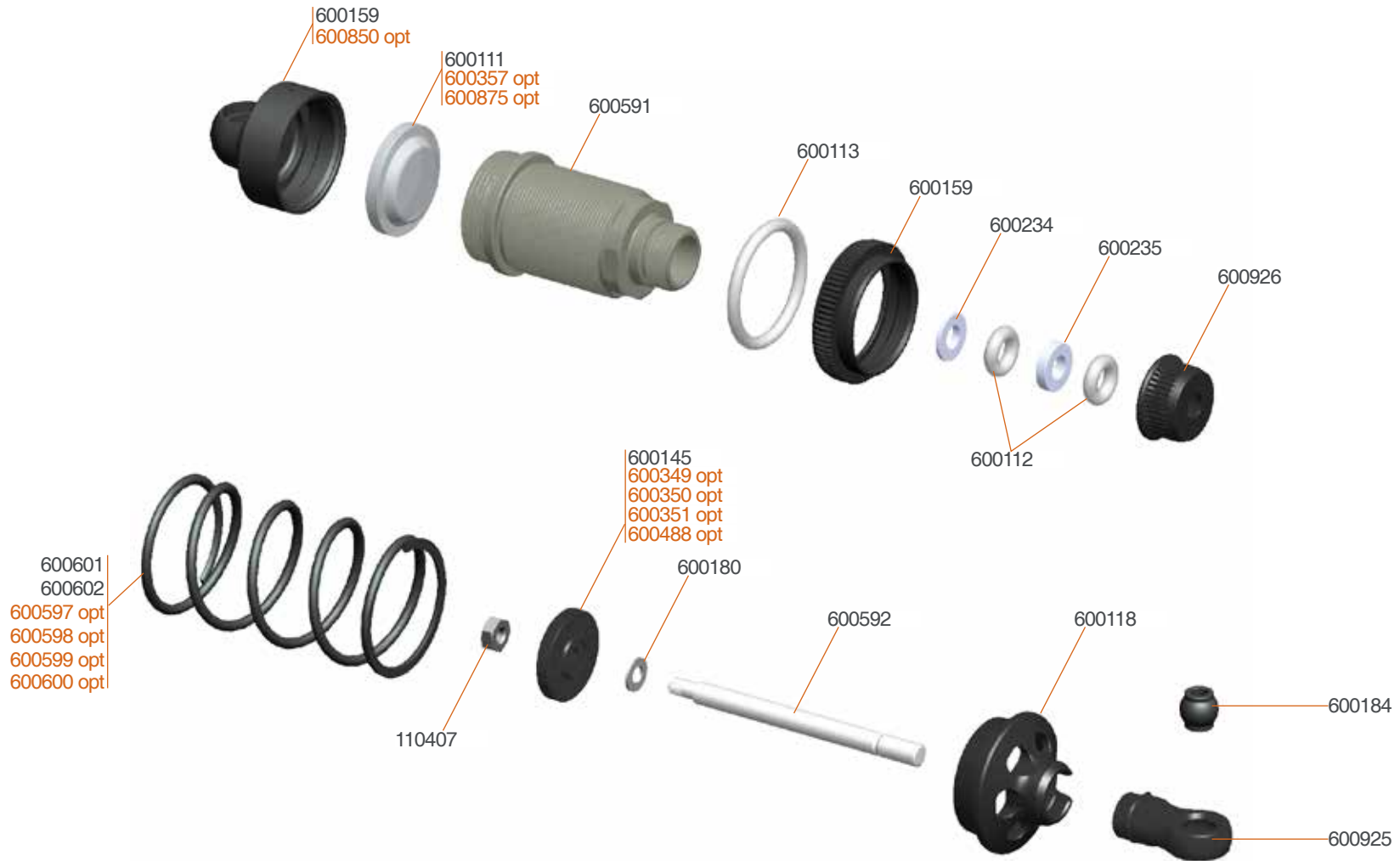

600595 Shockset fr/rr 811GT (2)
 600597 Spring Fr/Rr Red 811GT 18lbs (2)
 600598 Spring Fr/Rr Purple 811GT 21lbs
 600599 Spring Fr/Rr Yellow 811GT 29lbs

600600 Spring Fr/Rr White 811GT 31.5lbs
 600357 Membrane webbed silicone (4)
 600875 Shock top gasket (4) SRX8
 600349 Shock pistons conical 6 hole (4)

600350 Shock pistons conical 8 hole (4)
 600351 Shock pistons conical 10 hole (4)
 600488 Shock pistons square 8 hole (4)
 600850 Shock cap pro hard coated (2) SRX8

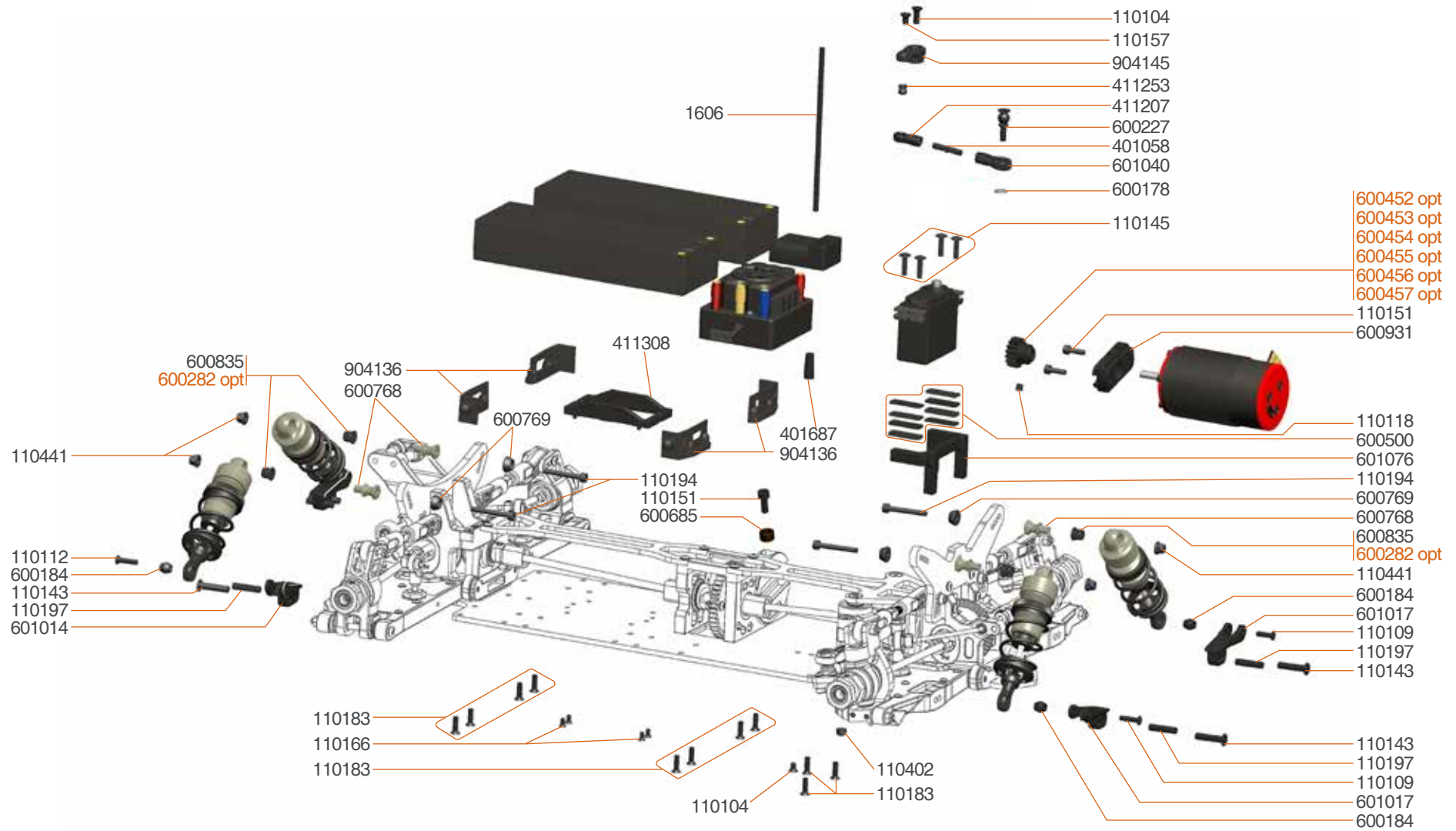

- 600282 Shock bushing delrin (4)
- 600452 Pinion 12T
- 600453 Pinion 13T
- 600454 Pinion 14T
- 600455 Pinion 15T

- 600456 Pinion 16T
- 600457 Pinion 17T

BUMPER AND BODYMOUNT EXPLODED VIEW

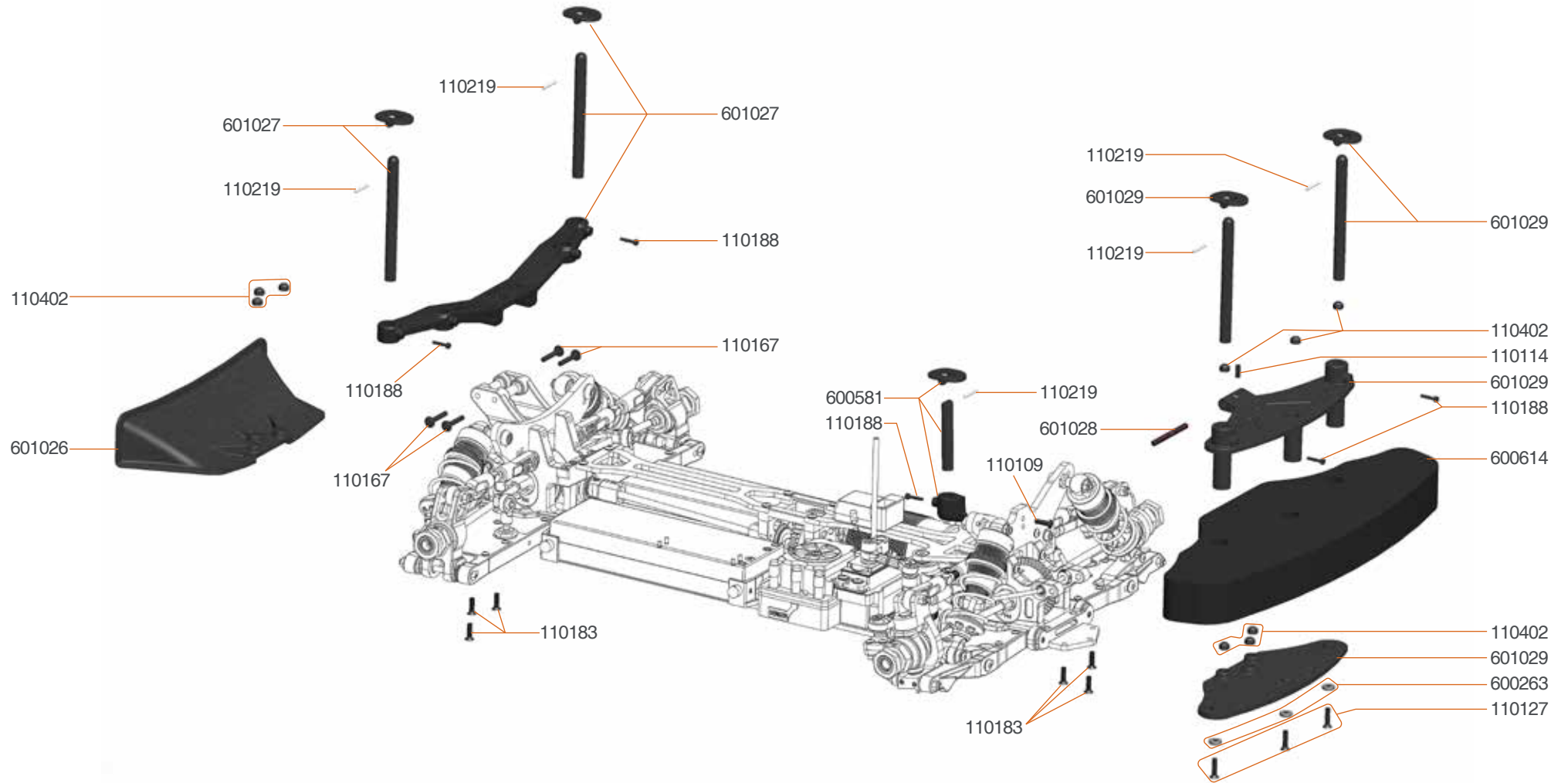

- 601050 Bumperplate carbon set SRX8 GT
- 601051 Bodypost brace carbon fr/rr SRX8 GT

TEAM SERPENT NETWORK

SRX8 GTE SPARE PARTS www.serpent.com/600058/spares/



SRX8 GTE OPTIONALS PARTS www.serpent.com/600058/Optionals/



SERPENT TOOLS www.serpent.com/product/Tools/



SERPENT MERCHANDISING www.serpent.com/product/Merchandising/





SERPENT WEBSITE AND BLOG

www.serpent.com
www.teamserpent.com
www.dragon-rc.com

SERPENT PROMO PAGES <http://promo.serpent.com>

SERPENT FACEBOOK GROUPS <http://promo.serpent.com/indexfb.htm>

SERPENT ADVANCED MANUALS <http://promo.serpent.com/sam/>

SERPENT SOCIAL MEDIA



www.facebook.com/SerpentMRC



www.youtube.com/user/SerpentMRC



www.twitter.com/SerpentMRC



www.plus.google.com/+SerpentModelcars/posts



www.weibo.com/teamserpent

INSTRUCTION MANUAL

SRX8 GTE

1/8 SCALE

Instruction Manual



Manual SRX8 GTE #831911

SERPENT